

About Us

BITEBI is one of the leading cylinders manufactures and suppliers in China. Welcome to buy our low price and high-quality products from cylinders, pneumatic cylinders OEM service and ODM from your factory or company, and also welcome to check price with us.

Our production capacity, comprehensive services as well as abundant experience enable us to be your best choice. We look forward to your reply and to establish mutually beneficial trading relations between us.

Working Process

① Mold Design and Manufacturing

Able to design and produce Die Casting Mold.
Software: Pro

② Die Casting

Fully equipped with high pressure cold chamber die casting machines
All the die casting machines are with automatic feed, spraying, fetch robot arms.

③ CNC Machining

We tailor our machining approach for either low-volume or higher-volume production runs. Secondary machining such as tapping, milling, boring, surfacing, drilling, and threading are performed to your specifications.

④ Assembling End Product

Able to assemble various cylinders.
Able to assembly big bore cylinder up to 320mm.
Own testing equipment for cylinders.

BITEBI[®]



无锡比特比机械科技有限公司

Wuxi Bitebi Machinery Technology Co.,Ltd.

地址：江苏省无锡市惠山区钱桥溪南工业园金山路12号

Add: No.12 Jinshan Road, Wuxi, Jiangsu

电话Tel: +86-510-83692008

传真Fax: +86-510-83692009

手机M.P: 13361160018

网址Http://www.btbjx.com

E-mail: btb@btbjx.com

mark@btbjx.com

无锡比特比机械科技有限公司

WUXI BITEBI MACHINERY TECHNOLOGY CO.,LTD.

以诚待人 以信定企
Treat others with sincerity
The company decided to Yu Chengxin



CONTENTS 目录



	标准气缸B-DNC系列 Standard Cylinder B-DNC Series	1
	标准气缸B-DNG系列 Standard Cylinder B-DNG Series	7
	紧凑型气缸B-AND系列 Compact Cylinder B-AND Series	16
	标准气缸B-MB系列 Standard Cylinder B-MB Series	24
	标准气缸B-SI系列 Standard Cylinder B-SI Series	30
	标准气缸B-SC系列 Standard Cylinder B-SC Series	34

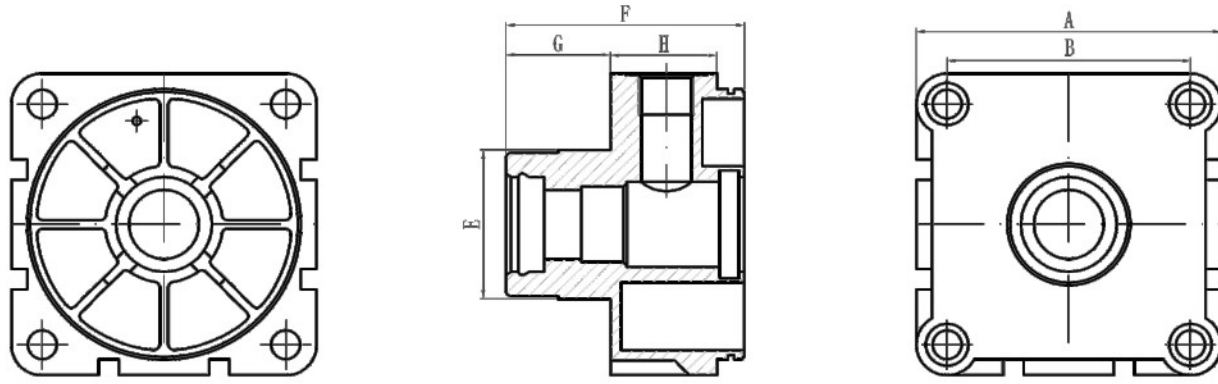

B-DNC φ32-φ125端盖/Head						
规格/Sp. 代号/Code	A	B	E	F	G	H
φ32	45.5	32.5	30	51	18	25
φ40	51.5	38	35	59	21.5	29.5
φ50	64.5	46.5	40	67.5	28	29.5
φ63	75.5	56.5	45	70.5	28.5	35.5
φ80	93.5	72	45	83.2	34.7	36
φ100	111.5	89	55	87.2	38.2	38.8
φ125	134	110	60	106	46	45

配件订购码/Kit Ordering Code

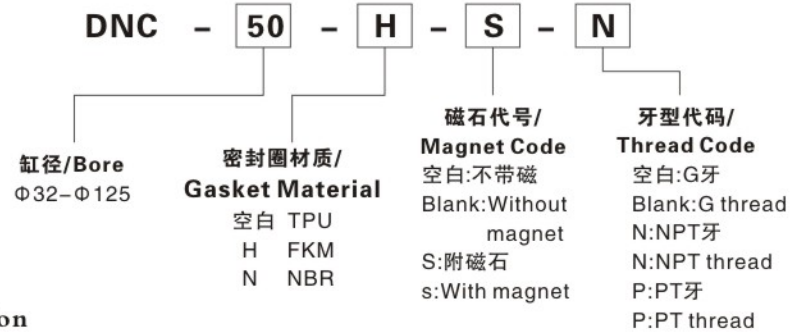

规格/Specification

内径/Bore (mm)	32	40	50	63	80	100	125
普通高温范围/Available temperature °C	-10~250						
缓冲行程/Cushioning travel (mm)	20	25	30	32			
接管口径/Port size	G1/8"	G1/4"	G3/8"	G1/2"			

标准型/Standard type

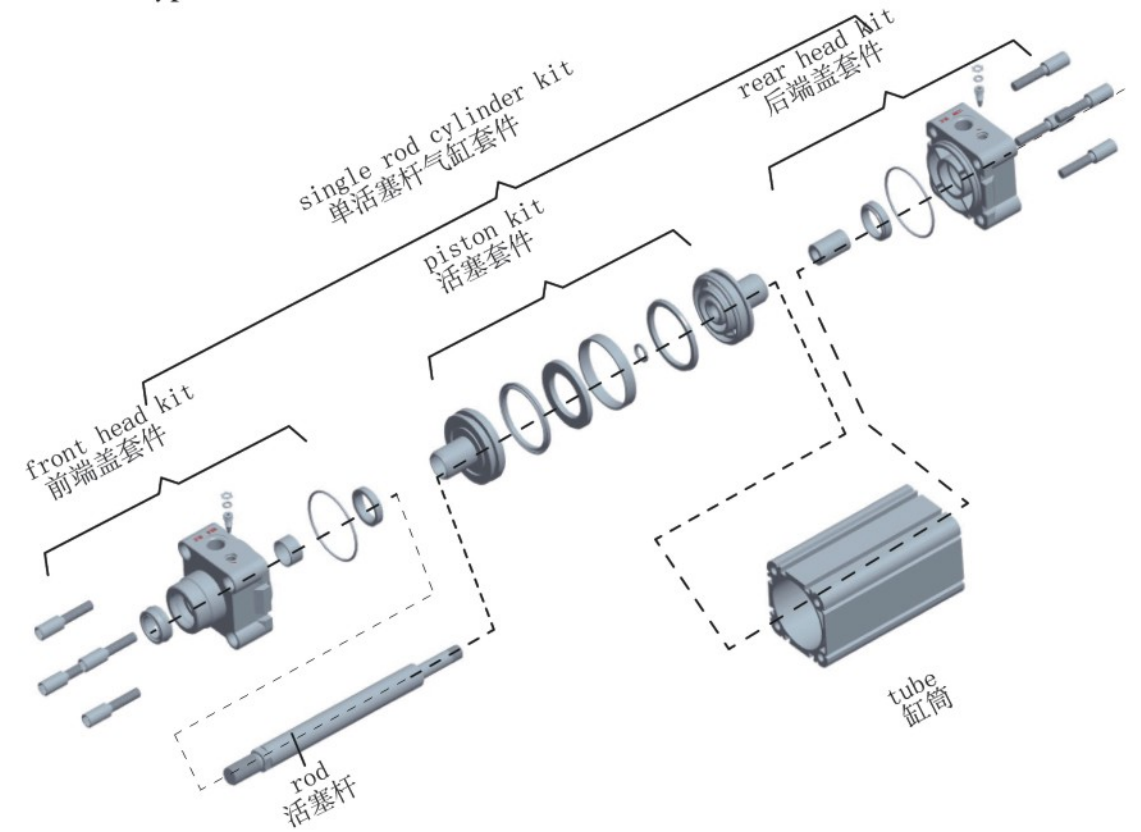

双轴型/Double shaft type

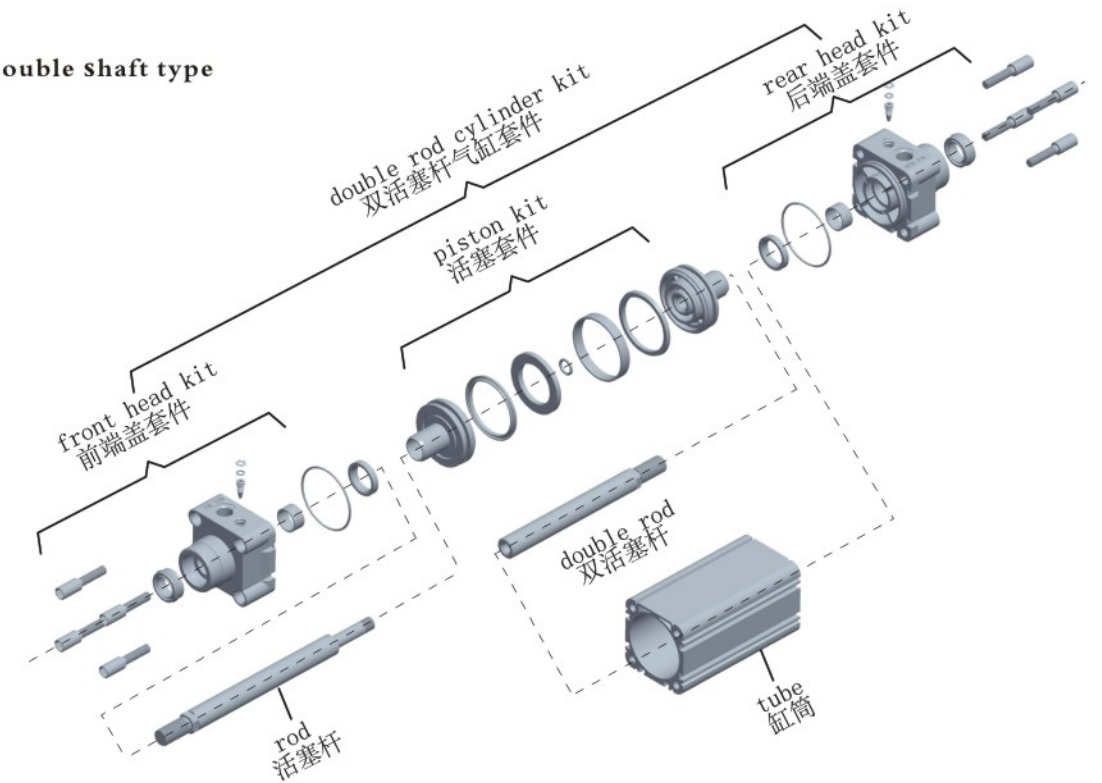

内部结构及主要零件材质/Inner structure and material list for main parts

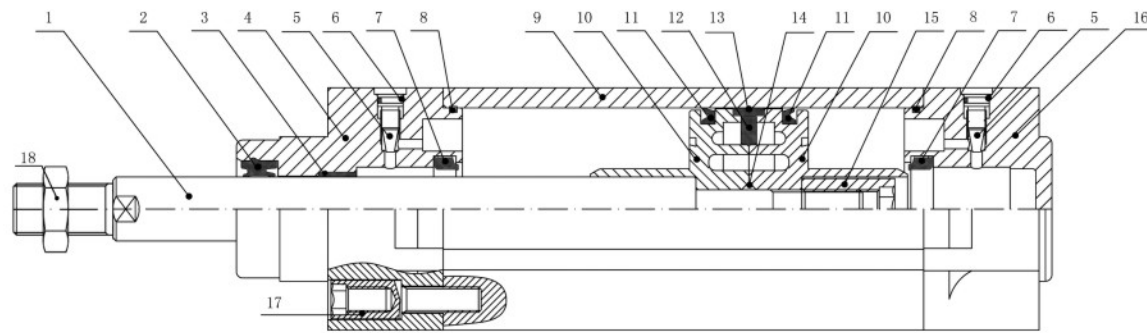

序号 No	名称 Name	材质 Material	序号 No	名称 Name	材质 Material
1	活塞杆 Piston rod	碳钢 Carbon steel	10	活塞 Piston	铝合金 Aluminum alloy
2	防尘圈 Anti dust seals	PU	11	活塞圈 Piston ring	NBR
3	含油轴承 Oil bearing	钢基粉末合金 Sinterized bronze	12	磁环 Magnet	铁氧体 Ferrite
4	前端盖 Front cover	铝合金 Aluminum alloy	13	导向带 Wearing ring	POM
5	针阀 Air cushioning screw	黄铜 Brass	14	轴芯垫 O-ring for piston and piston rod	NBR
6	针阀O型圈 O-ring for air cushioning screw	NBR	15	活塞螺帽 Nut for piston	碳钢 Carbon steel
7	缓冲圈 Cushioning seals	NBR	16	后端盖 Back cover	铝合金 Aluminium alloy
8	管壁O型圈 O-ring for front cover	NBR	17	拉杆螺丝 Tie-rod screw	碳钢 Carbon steel
9	缸筒 Tube	铝合金 Aluminium alloy	18	活塞杆螺帽 Nut for piston rod	碳钢 Carbon steel

密封件/Packing and O-Ring List

规格 Item	防尘圈 Rod packing	缓冲圈 Cushion packing	端盖O型圈 End cover O-Ring	磁环 Magnetic Ring	活塞圈 Piston	轴心圈 Piston O-Ring	缓冲O型圈 Cushion O-Ring
数量 No.	1	2	2	1	2	1	2
直径 Bore size mm							
φ32	BEU-1219	BPP-1622	φ32※φ2	φ28※φ16※5	B-QZ8-3224	φ12※φ2	φ8※φ1.5
φ40	BEU-1626	BPP-2028	φ40※φ2	φ36※φ20※5	B-QZ8-4032	φ14※φ2.4	φ8※φ1.5
φ50	BEU-2030	BPP-2533	φ50※φ2	φ46※φ22※5	B-QZ8-5042	φ16※φ2.4	φ8※φ1.5
φ63	BEU-2030	BPP-2533	φ63※φ2	φ59※φ40※5	B-QZ8-6353	φ16※φ2.4	φ8※φ1.5
φ80	BEU-2535	BPP-3040	φ80※φ2	φ76※φ58※5	B-QZ8-8070	φ20※φ2.4	φ8※φ1.5
φ100	BEU-2535	BPP-3040	φ100※φ2	φ96※φ77※5	B-QZ8-10090	φ20※φ2.4	φ8※φ1.5
φ125	BEU-3242	BPP-4050	φ125※φ3.5	φ120※φ96※5	B-QGP φ110※9.5	φ20※φ2.4	φ12※φ1.5

基本尺寸/Basic specification

φ32~φ125

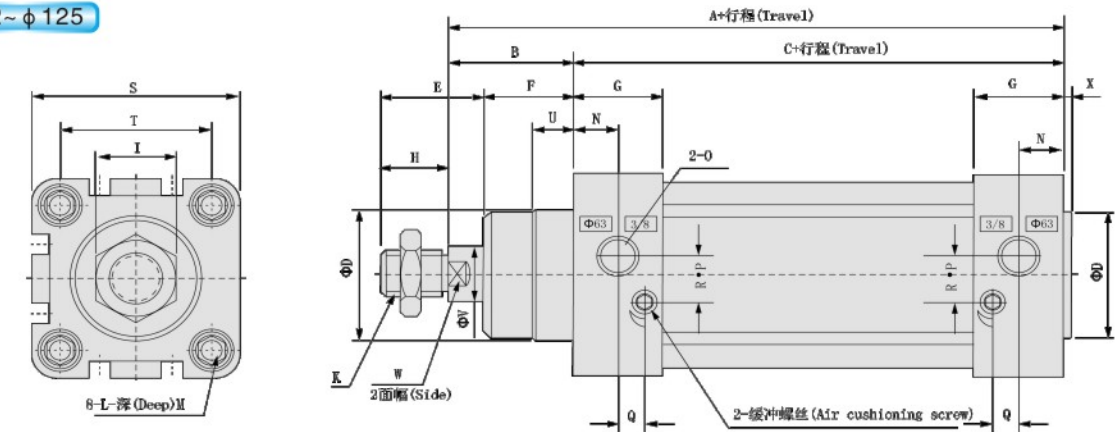

基本尺寸/Basic specification

φ32~φ125

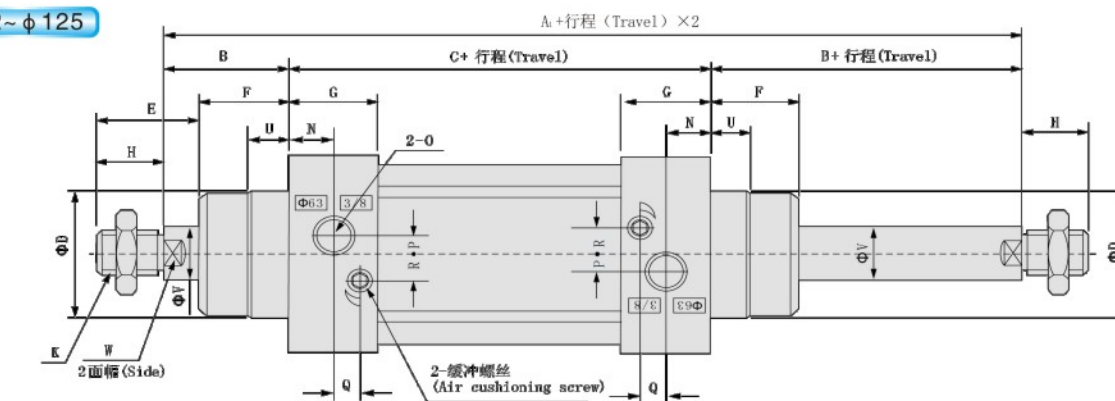

内径/符号 (Bore/Symbol)	A	A ₁	B	C	D	E	F	G	H	I	K	L
32	120	146	26	94	30	30	18	25	22	17	M10×1.25	M6
40	135	165	30	105	35	32.5	21.5	29.5	24	17	M12×1.25	M6
50	143	180	37	106	40	41	28	29.5	32	23	M16×1.5	M8
63	158	195	37	121	45	40.5	28.5	35.5	32	23	M16×1.5	M8
80	174	220	46	128	45	51.3	34.7	36	40	26	M20×1.5	M10
100	189	240	51	138	55	52.8	38.2	38.8	40	26	M20×1.5	M10
125	225	291	65	160	60	73	46	45	54	41	M27×2	M12

内径/符号 (Bore/Symbol)	M	N	O	P	Q	R	S	T	U	V	W	X
32	9.5	12.6	G1/8	5.5	5.5	7.1	45	32.5	10	12	10	4
40	9.5	14.6	G1/4	6	7	7.5	54	38	10	16	13	4
50	9.5	14.6	G1/4	8.5	4.5	8.5	64	46.5	11.5	20	17	4
63	9.5	18.1	G3/8	10	2	12	75	56.5	15	20	17	4
80	11.5	17.9	G3/8	12.7	1	8	93	72	15.7	25	22	4
100	11.5	19.8	G1/2	11.8	4	10	110	89	19.2	25	22	4
125	11.5	18	G1/2	8	14	13	134	110	20.5	32	27	6

安装附件/Mounting kits

B-DNC-LB

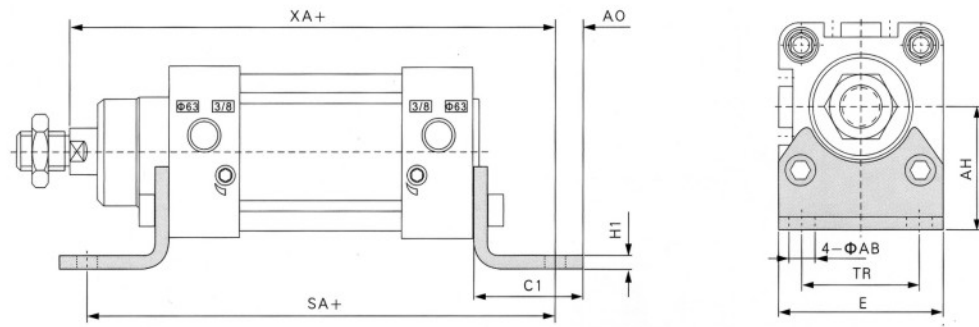

缸径/Bore(mm)	AB	AH	AO	CI	E	H1	SA	TR	XA
32	7	32	6.5	30.5	45	5	142	32	144
40	10	36	9	37	54	5	161	36	163
50	10	45	9.5	41.5	64	6	170	45	175
63	10	50	12.5	44.5	75	6	185	50	190
80	12	63	15	56	93	6	210	63	215
100	14.5	71	17.5	58.5	110	6	220	75	230
125	16.5	90	22	67	131	8	250	90	270

B-DNC-FA、FB

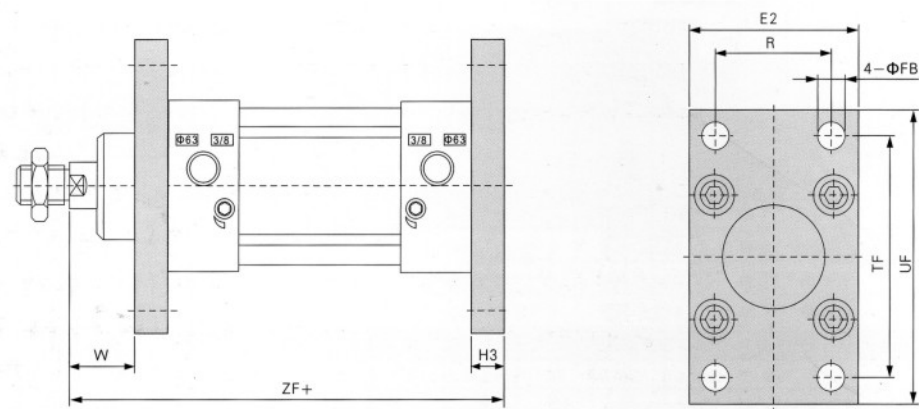

缸径/Bore(mm)	E2	FB _{H13}	H3	R	TF	UF	W	ZF
32	50	7	10	32	64	80	16	130
40	55	9	10	36	72	90	20	145
50	65	9	12	45	90	110	25	155
63	75	9	12	50	100	125	25	170
80	100	12	16	63	126	154	30	190
100	120	14	16	75	150	186	35	205
125	140	16	20	90	180	220	45	245

安装附件/Mounting kits

B-DNC-CA

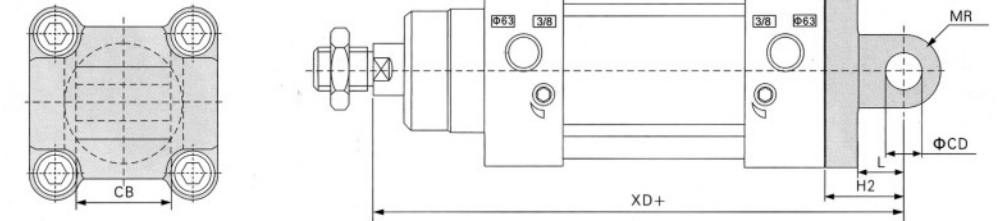

B-DNC-CB

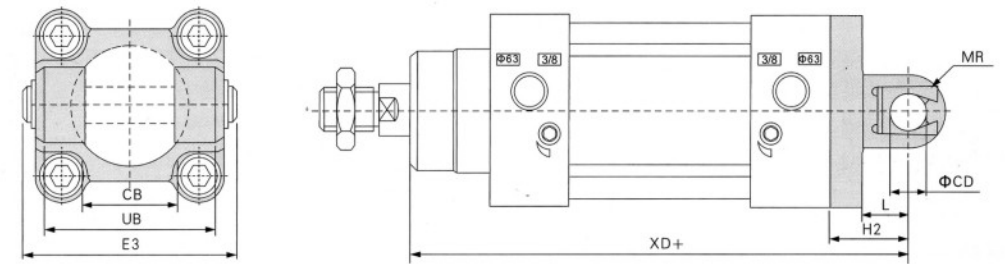

缸径/Bore(mm)	CB	CD	E3	H2	L	MR	UB	XD
32	26	10	55	22	13	10	45	142
40	28	12	63	25	16	12	52	160
50	32	12	71	27	16	12	60	170
63	40	16	83	32	21	16	70	190
80	50	16	103	36	22	16	90	210
100	60	20	127	41	27	20	110	230
125	70	25	148	50	30	25	130	275

B-DNC-TC

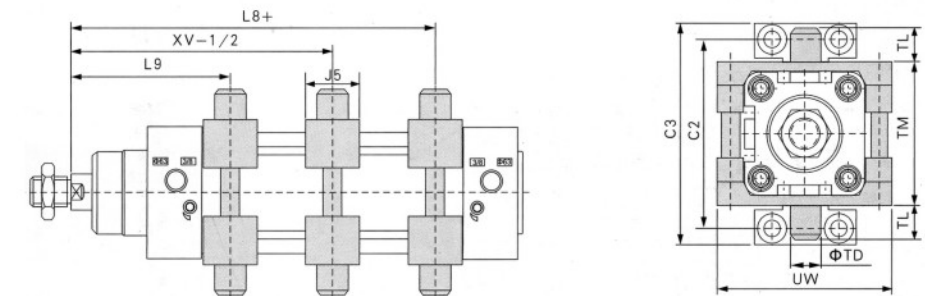

缸径/Bore(mm)	C2	C3	J5	L8	L9	TD	TL	TM	UW	XV
32	71	86	30	79.9	66.1	12	12	50	65	73
40	87	105	32	89.4	75.6	16	16	63	75	82.5
50	99	117	34	94.4	83.6	16	16	75	95	90
63	116	136	41	101.9	93.1	20	20	90	105	97.5
80	136	156	44	118.1	103.9	20	20	110	130	110
100	164	189	48	126.2	113.8	25	25	132	145	120
125	192	217	50	155.3	134.7	25	25	160	175	145

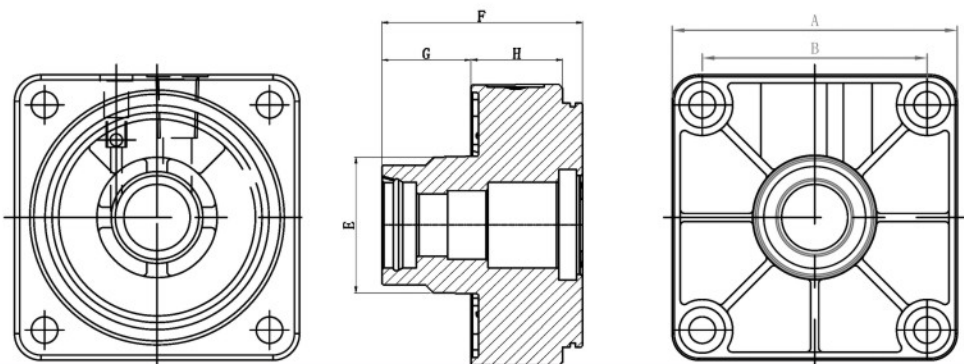

B-DNG φ32-φ320 端盖/Head						
规格/Sp. 代号/Code	A	B	E	F	G	H
φ32	47	32.5	φ30	52	19	27
φ40	53	38	φ35	58.5	21	31
φ50	65	46.5	φ40	66.5	27	31
φ63	75	56.5	φ45	69	27	33
φ80	95	72	φ45	81.5	33	36
φ100	115	89	φ55	85	36	37
φ125	140	110	φ60	100.5	40	45
φ160	180	140	φ65	120	55	50
φ200	220	175	φ75	131	67	50
φ250	270	220	φ90	149	75	60
φ320	350	270	φ110	170	90	65

配件订购码/Kit Ordering Code

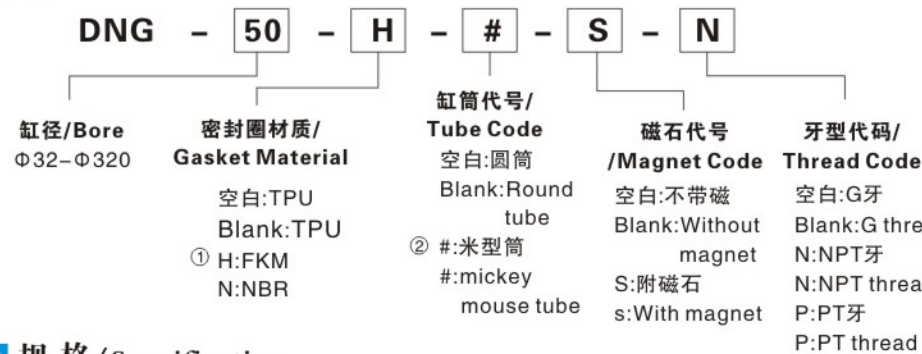

注: ① φ32-φ125高温防尘圈是EU,
φ160-φ250高温防尘圈是DRP,
φ320高温防尘圈是JD。
② #米型筒直径最大200。

Remark:
① φ32-φ125high temperature anti dust wiper,
φ160-φ250high temperature anti dust wiper,
φ320high temperature anti dust wiper.
② # mickey mouse tube maximum diameter 200.

规格/Specification

内径/Bore (mm)	32	40	50	63	80	100	125	160	200	250	320
普通高温范围/Available temperature °C	-10~250										
缓冲行程/Cushioning travel (mm)	20	25	30	32	40	50					
接管口径/Port size	G1/8	G1/4	G3/8	G1/2	G3/4	G1"					

标准型/Standard type

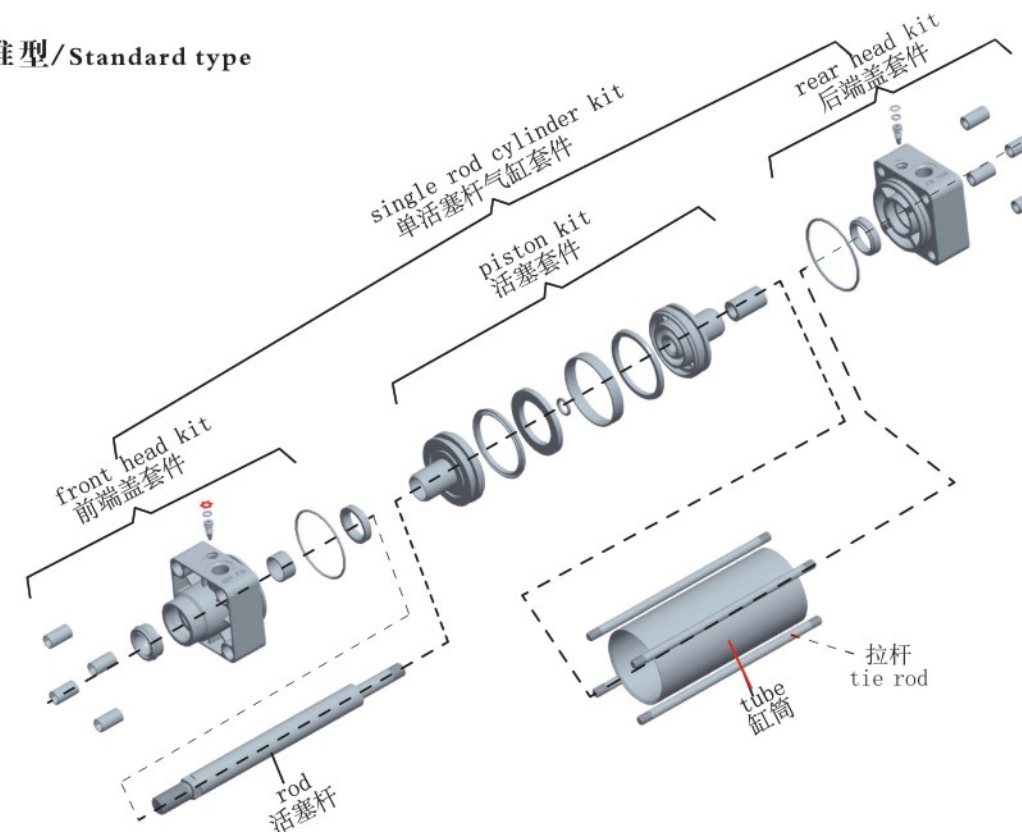

双轴型/Double shaft type

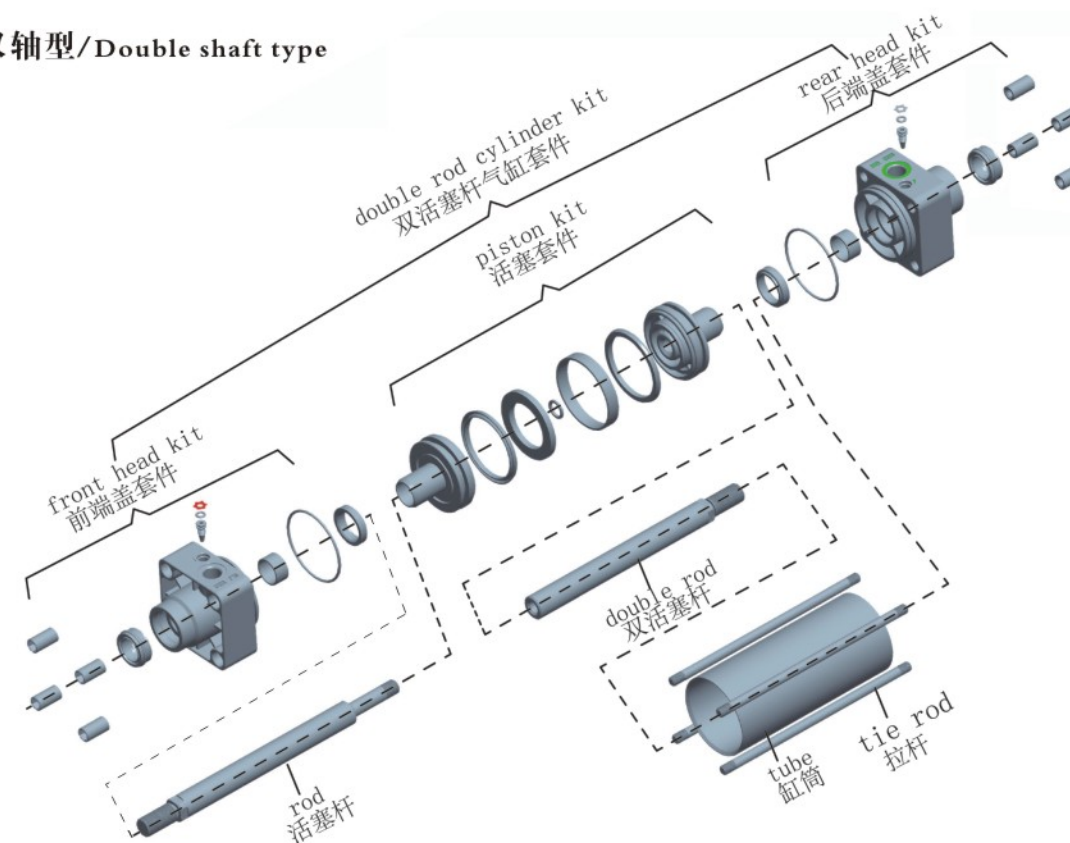

内部结构及主要零件材质/Inner structure and material list for main parts

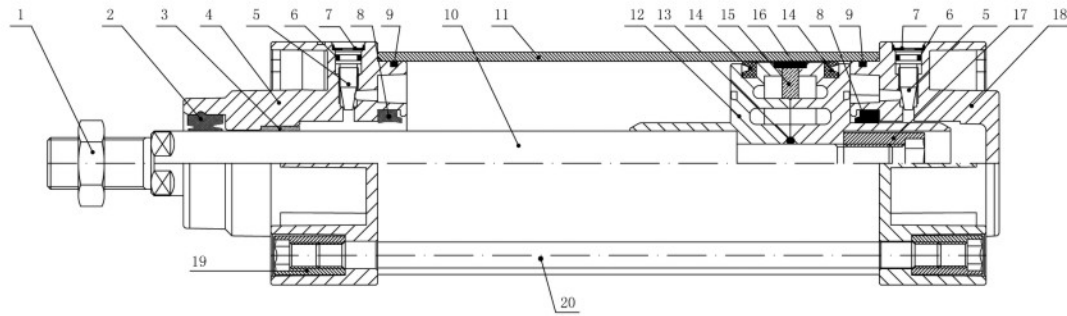

序号 No	名称 Name	材质 Material	序号 No	名称 Name	材质 Material
1	活塞杆螺帽 Nut for piston rod	碳钢 Carbon steel	11	缸筒 Tube	铝合金 Aluminium alloy
2	防尘圈 Anti dust seals	PU	12	活塞 Piston	铝合金 Aluminium alloy
3	含油轴承 Oil bearing	钢基粉末合金 Sinterized bronze	13	轴芯垫 O-ring for piston and piston rod	NBR
4	前端盖 Front cover	铝合金 Aluminium alloy	14	活塞圈 Piston ring	NBR
5	针阀 Air cushioning screw	59铜 H59 brass	15	磁环 Magnet	铁氧体 Ferrite
6	针阀O型圈 O-ring for air cushioning screw	NBR	16	导向带 Wearing ring	POM
7	针阀卡环 Snap ring for air cushion hole screw	弹簧钢 Spring steel	17	活塞固定螺帽 Nut for piston and piston rod fixed	碳钢 Carbon steel
8	缓冲圈 Cushioning seals	NBR	18	后端盖 Back cover	铝合金 Aluminium alloy
9	管壁O型圈 O-ring for front cover	NBR	19	拉杆螺帽 Tie-rod nuts & screw	碳钢 Carbon steel
10	活塞杆 Piston rod	碳钢 Carbon steel	20	拉杆 Tie-rod	碳钢 Carbon steel

密封件/Packing and O-Ring List

规格 item	防尘圈 Rod packing	缓冲圈 Cushion packing	端盖O型圈 End cover O-Ring	磁环 Magnetic Ring	活塞圈 Piston	轴心圈 Piston O-Ring	缓冲O型圈 Cushion O-Ring
直径 Bore size mm	数量No. 1	数量No. 2	数量No. 2	数量No. 1	数量No. 2	数量No. 1	数量No. 2
φ32	BEU-1219	BPP-1622	φ32※φ2	φ28※φ16※5	B-QZ8-3224	φ12※φ2	φ8※φ1.5
φ40	BEU-1626	BPP-2028	φ40※φ2	φ36※φ20※5	B-QZ8-4032	φ14※φ2.4	φ8※φ1.5
φ50	BEU-2030	BPP-2533	φ50※φ2	φ46※φ22※5	B-QZ8-5042	φ16※φ2.4	φ8※φ1.5
φ63	BEU-2030	BPP-2533	φ63※φ2	φ59※φ40※5	B-QZ8-6353	φ16※φ2.4	φ8※φ1.5
φ80	BEU-2535	BPP-3040	φ80※φ2	φ76※φ58※5	B-QZ8-8070	φ20※φ2.4	φ8※φ1.5
φ100	BEU-2535	BPP-3040	φ100※φ2	φ96※φ77※5	B-QZ8-10090	φ20※φ2.4	φ8※φ1.5
φ125	BEU-3242	BPP-4050	φ125※φ3.5	φ120※φ96※6	B-QGPφ110※9.5	φ20※φ2.4	φ12※φ1.5

规格 item	防尘圈 Rod packing	缓冲圈 Cushion packing	端盖O型圈 End cover O-Ring	磁环 Magnetic Ring	活塞圈 Piston	轴心圈 Piston O-Ring	缓冲O型圈 Cushion O-Ring
直径 Bore size mm	数量No. 1	数量No. 2	数量No. 2	数量No. 2	数量No. 2	数量No. 1	数量No. 2
φ160	BEU-4050 BB3-4048	BPP-5060	φ160※φ4	φ155※φ131.5※6	B-QGPφ145※9.5	φ40※φ3.1	φ12※φ1.5
φ200	BEU-4050 BB3-4048	BPP-5060	φ200※φ4	φ195※φ172※6	B-QZ8φ180※φ8.5	φ40※φ3.1	φ12※φ1.5
φ250	BEU-5060 BB3-5058	BPP-5774	φ250※φ4	φ245※φ222※6	B-QGPφ230※φ14	φ38※φ4	φ16※φ2
φ320	BEU-6375 BB3-6373	BPP-7895	φ320※φ5	φ315※φ292※6	B-QGPφ295※φ14	φ43※φ3.5	φ16※φ2

外部规格/Overall dimension

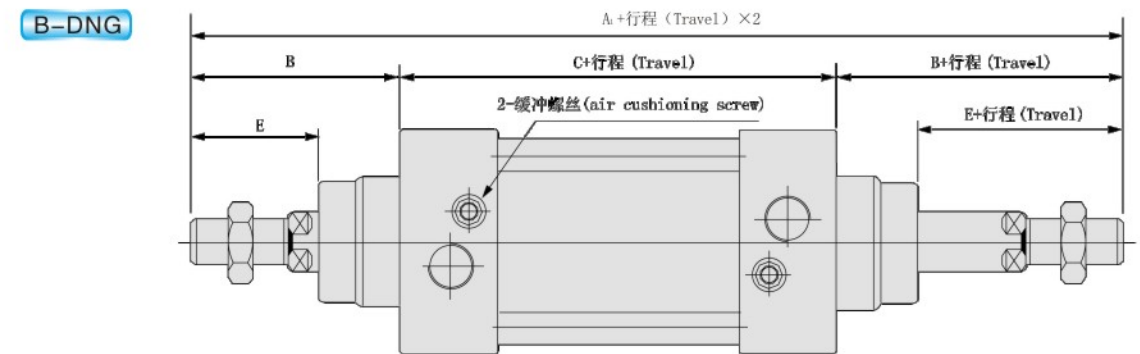
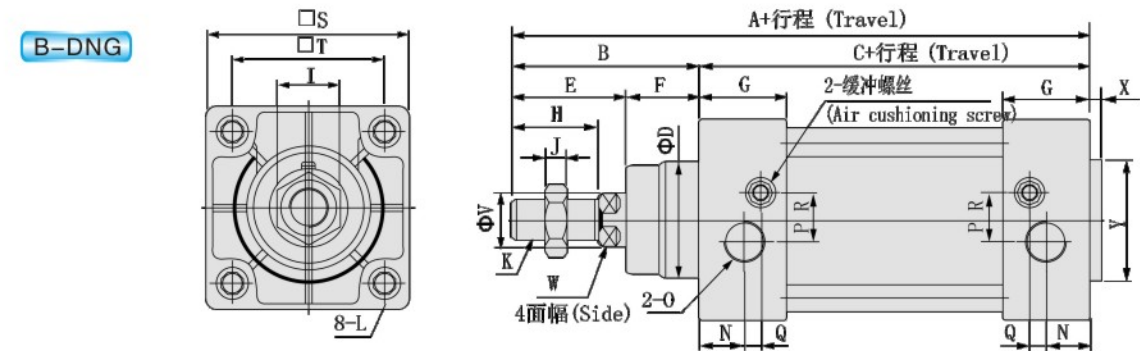

内径/符号 (Bore/Symbol)	A	A ₁	B	C	D	E	F	G	H	I	J	K	L	N
32	142	190	48	94	30	29	19	27	22	17	6	M10×1.25	M6	12
40	159	213	54	105	35	33	21	31	24	17	7	M12×1.25	M6	15
50	175	244	69	106	40	42	27	31	32	23	8	M16×1.5	M8	15.5
63	190	259	69	121	45	42	27	33	32	23	8	M16×1.5	M8	16.5
80	214	300	86	128	45	53	33	36	40	26	10	M20×1.5	M10	19
100	229	320	91	138	55	55	36	37	40	26	10	M20×1.5	M10	18
125	279	398	119	160	60	79	40	45	54	41	13.5	M27×2	M12	23
160	332	484	152	180	65	94	55	50	72	55	18	M36×2	M16	25
200	347	514	167	180	75	100	67	50	72	55	18	M36×2	M16	25
250	389	578	189	200	90	114	75	60	84	64	20	M42×2	M20	30
320	436	652	216	220	110	126	90	65	96	72	20	M48×2	M24	30

内径/符号 (Bore/Symbol)	O	P	Q	R	S	T	V	W	X	Y
32	G1/8	5.5	7	6	47	32.5	12	10	3	30
40	G1/4	6	6	8.5	53	38	16	13	3.5	35
50	G1/4	7.5	6.5	8.5	65	46.5	20	17	3.5	40
63	G3/8	7.5	7.5	11.5	75	56.5	20	17	4	45
80	G3/8	8.5	7.5	13.5	95	72	25	22	4	45
100	G1/2	9.5	8.5	13.5	115	89	25	22	4	55
125	G1/2	10	12	18	140	110	32	27	4	60
160	G3/4	15	12	15	180	140	40	36	4	65
200	G3/4	15	12	20	220	175	40	36	5	75
250	G1	20	10	25	270	220	50	46	8	90
320	G1	30	15	35	350	270	63	55	10	110

附件/Mounting kits

外部规格/Outside dimension

B-FA

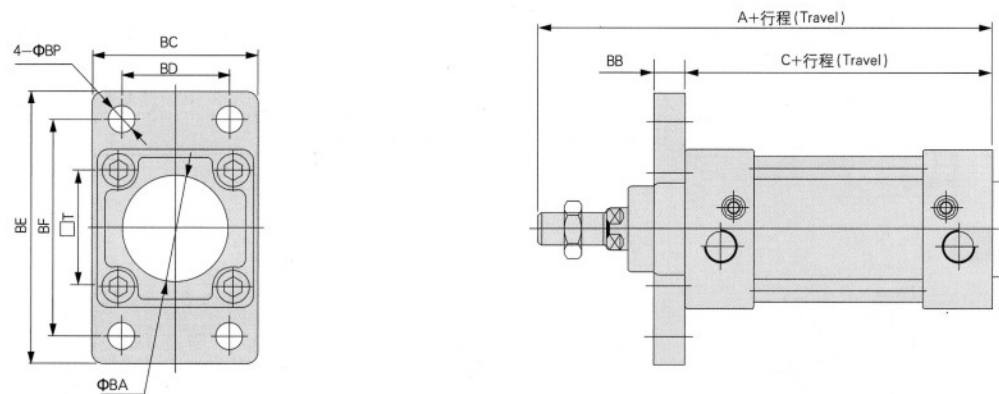

B-FB

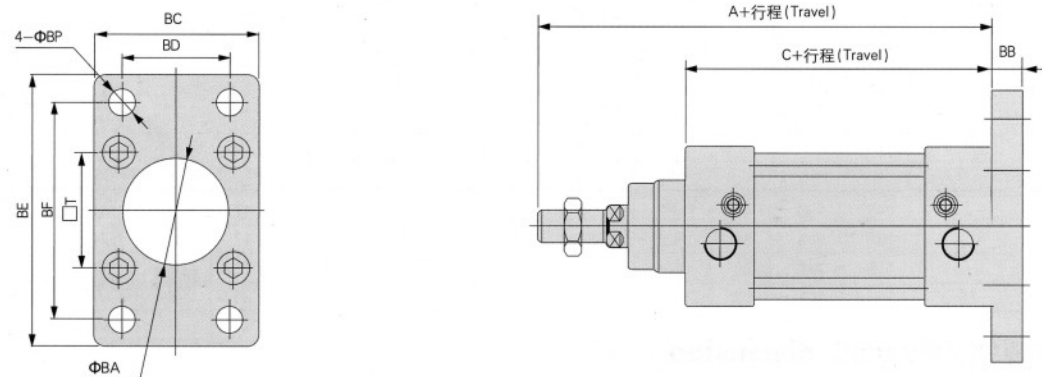

符号/内径(Symbol/Bore)	32	40	50	63	80	100	125	160	200	250	320
A	142	159	175	190	214	229	279	332	347	389	436
C	94	105	106	121	128	138	160	180	180	200	220
BA	30	35	40	45.5	45	55	61	66	76	91	110
BB	10	10	12	12	16	16	20	20	25	25	30
BC	45	52	65	75	95	115	139	180	220	270	349
BD	32	36	45	50	63	75	90	115	135	165	200
BE	80	90	110	120	150	175	220	280	320	390	470
BF	64	72	90	100	126	150	180	230	270	330	400
BP	7	9	9	9	12	14	16	18	22	26	33
T	32.5	38	46.5	56.5	72	89	110	140	175	220	270

附件/Mounting kits

附件材质/Accessories material

缸径/Bore	安装附件/Install accessories										连接附件/Connector kits	
	LB	FA	FB	CR	CA	CB	TC	FTC	TF	TM	I, Y	F, U
32-100	低碳钢 Low carbon steel	铝合金 Aluminium alloy				铸铁 Cast steel				铝合金 Aluminium alloy	碳钢 Carbon steel	
125-320	碳钢/Carbon steel											

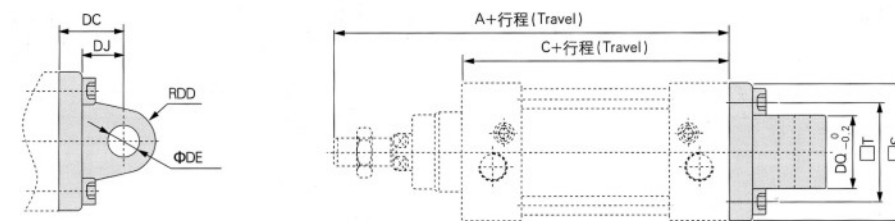

符号/内径(Symbol/Bore)	32	40	50	63	80	100	125	160	200	250	320
A	142	159	175	190	214	229	279	332	347	389	436
C	94	105	106	121	128	138	160	180	180	200	220
S	47	52	64	74	94	113	139	180	220	210	350
T	32.5	38	46.5	56.5	72	89	110	140	175	220	270
DC	22	25	27	32	36	41	50	55	60	70	80
DD	9	10.5	11	13.5	14.5	17	22	25	25	40	45
DE	10	12	12	16	16	20	25	30	30	40	45
DJ	13	16	17	22	22	27	33	35	35	47	52
DQ	25.8	27.5	31.7	39.7	49.7	59.7	69.7	90	90	110	120

外部规格/Overall dimension

B-CB

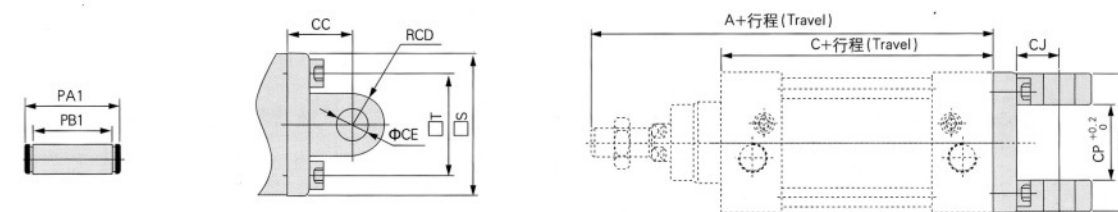

符号/内径(SYMBOL/BORE)	32	40	50	63	80	100	125	160	200	250	320
A	142	159	175	190	214	229	279	332	347	389	436
C	94	105	106	121	128	138	160	180	180	200	220
CC	22	25	27	32	36	41	50	55	60	70	80
CD	9	10.5	11	13	14	17.5	21.5	30	30	40	45
CE	10	12	12	16	16	20	25	30	30	40	45
CJ	13	16	17	22	22	27	31	35	35	47	52
CP	26	28	32	40	50	60	70	90	90	110	120
CT	45	52	60	70	90	110	130	170	170	200	220
PA1	51	59	67	77	97	119	139	181	181	220	240
PB1	45.5	52.5	60.5	70.5	90.5	10.5	130.5	70.5	170.5	202	222
S	47	52	64	74	94	113	139	180	220	270	350
T	32.5	38	46.5	56.5	72	89	110	140	175	220	270

附件/Mounting kits

B-LB

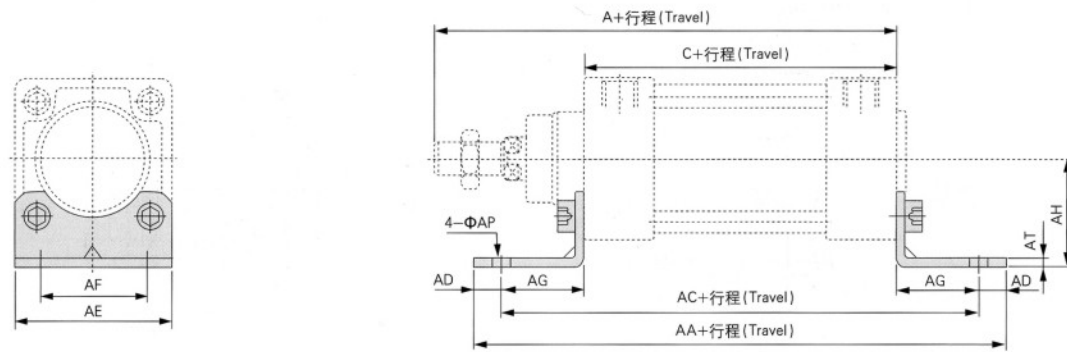

符号/内径(Symbol/Bore)	32	40	50	63	80	100	125	160	200	250	320
A	142	159	175	190	214	229	279	332	347	389	436
C	94	105	106	121	128	138	160	180	180	200	220
AA	158	179	190	209	248	266	290	340	380	420	470
AC	142	161	170	185	210	228	250	300	320	350	390
AD	8	9	10	12	19	19	20	20	30	35	40
AE	47	53	65	75	95	115	140	180	220	270	350
AF	32	36	45	50	63	75	90	115	135	165	200
AG	24	28	32	32	41	45	45	60	70	75	85
AH	32	36	45	50	63	71	90	115	135	165	185
AP	7	9	9	9	12.5	14.5	16.5	18	22	28	35
AT	3	3	3	3	4	4	8	8	9	20	23

B-TC

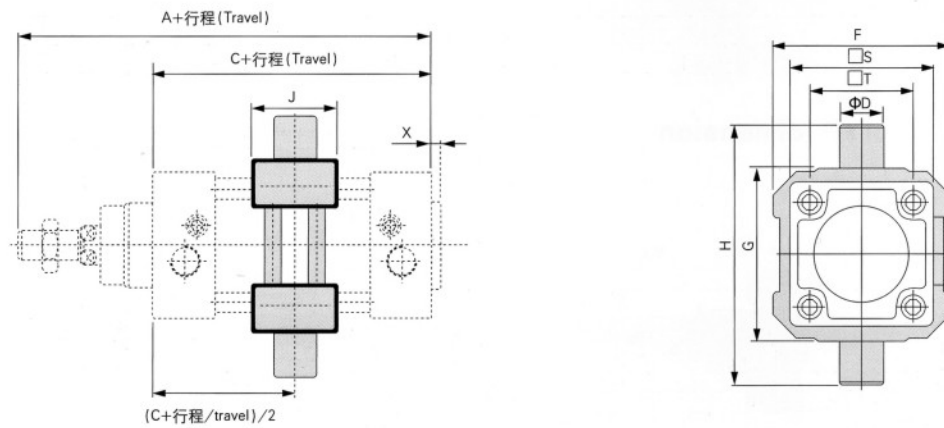

注：附件安装位置不可任意调整/Remark: install position can not be changed.

内径/符号(Bore/Symbol)	A	C	D	F	G	H	J	S	X	T
32	142	94	12	52	50	74	22	47	3	32.5
40	159	105	16	65	63	95	28	53	3.5	38
50	175	106	16	75	75	107	28	65	3.5	46.5
63	190	121	20	90	90	130	30	75	4	56.5
80	214	128	20	112	110	150	32	95	4	72
100	229	138	25	135	132	182	38	115	4	89
125	279	160	25	170	160	210	40	140	4	110
160	332	180	32	210	200	264	50	180	4	140
200	347	180	32	255	250	314	50	220	5	175

附件/Mounting kits

B-TF

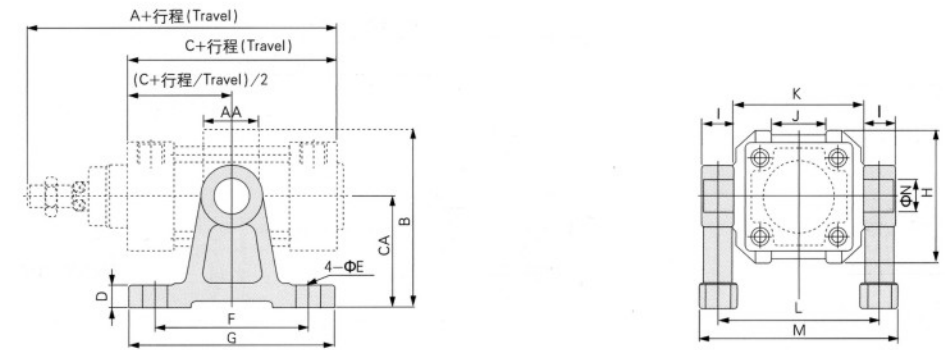

注：附件安装位置不可任意调整/Remark: install position can not be changed.

符号/内径(Symbol/Bore)	32	40	50	63	80	100	125	160	200
A	142	159	175	190	214	229	279	332	347
AA	22	28	28	30	32	38	40	50	50
B	66	86.5	91.5	115	126	157.5	175	215	262.5
C	94	105	106	121	128	138	160	180	180
CA	40	54	54	70	70	90	90	110	135
D	11	11	11	11	11	19	19	24	27
E	9	12	12	12	12	18	18	22	22
F	60	75	75	85	85	115	115	140	150
G	80	100	100	110	110	155	155	190	200
H	52	65	75	90	112	135	170	210	255
I	12	16	16	20	20	25	25	32	32
J	20	27	31	42	54	68	80	100	125
K	50	63	75	90	110	132	160	200	250
L	62	79	91	110	130	157	185	232	282
M	77	98	110	133	153	185	213	267	317
N	12	16	16	20	20	25	25	32	32

B-FTC

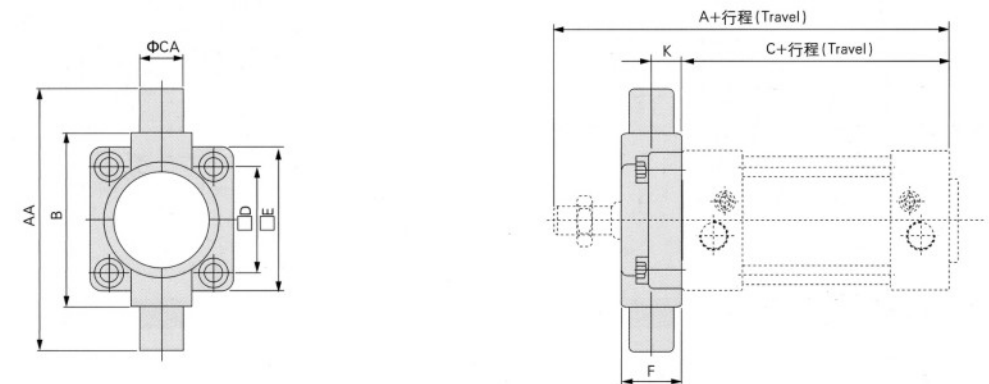

符号/内径(Symbol/Bore)	32	40	50	63	80	100	125	160	200
A	142	159	175	190	214	229	279	332	347
AA	74	95	107	130	150	182	210	264	314
B	50	63	75	90	110	132	160	200	250
C	94	105	106	121	128	138	160	180	180
CA	12	16	16	20	20	25	25	32	32
D	32.5	38	46.5	56.5	72	89	110	140	175
E	46	52	64	74	94	114	139	179	218
F	19	21	26	28	31	35	43	56	64
K	10	10	12	12	16	16	20	20	20

附件/Mounting kits

B-SNCS

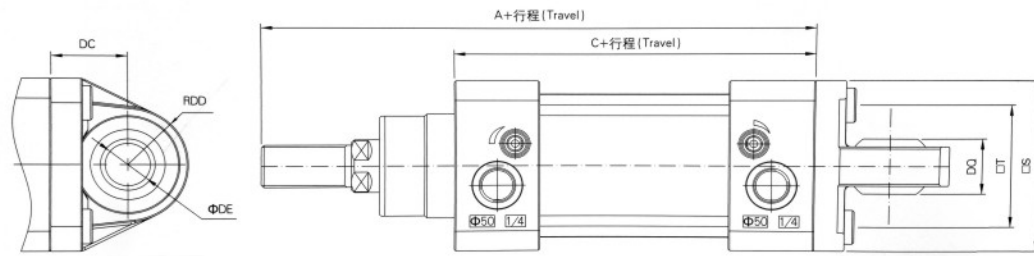

符号/内径(Symbol/Bore)	32	40	50	63	80	100	125
A	142	159	175	190	214	229	279
C	94	105	106	121	128	138	160
S	47	53	65	75	95	115	140
T	32.5	38	46.5	56.5	72	89	110
DC	22	25	27	32	36	41	50
DD	16	19	21	24	28.5	30	40
DE	10	12	16	16	20	20	30
DQ	14	16	21	21	25	25	37

B-LNG与CB配合用/LNG Working with CB

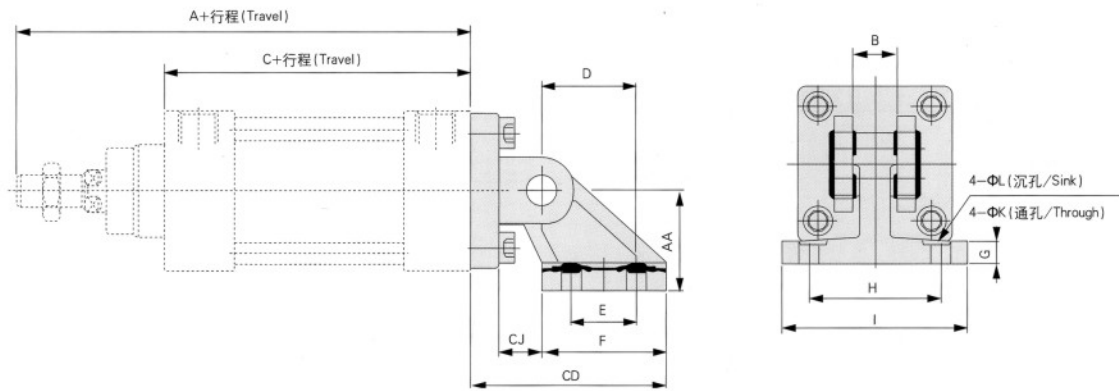

符号/内径(Symbol/Bore)	32	40	50	63	80	100	125
A	142	159	175	190	214	229	279
AA	32	36	45	50	63	71	90
B	26	28	32	40	50	60	70
C	94	105	106	121	128	138	160
CD	50	56	68	77	93	106	135
CJ	10	12	13	17	19	22	26
D	21	24	33	37	47	55	70
E	18	22	30	35	40	50	60
F	31	35	45	50	60	70	90
G	8	10	12	14	14	17	20
H	38	41	50	52	66	76	94
I	51	54	65	67	86	96	124
K	6.6	6.6	9	9	11	11	14
L	-	-	-	-	18	18	21

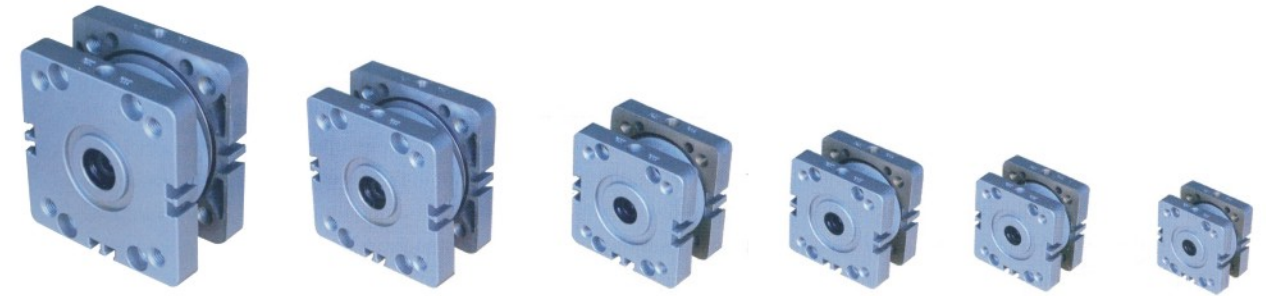

配件订购码/Kit Ordering Code

ADN - S - 20 × 30 - B - LB

型号/Model	感应磁石/Magnet	缸径/Bore	行程/Travel	牙型/Thread code	固定型式/ Mounting type
ADN:标准复动型 ADN: Standard double action	S:附磁石 S:With magnet 空白:不附磁 Blank:without magnet			空白: 内牙 Blank: Inner thread B: 外牙/Outer thread N: 无牙/Without thread	空白: 基本型/Basic LB: 脚架安装 /Foot mount FA/FB: 法兰安装 /Flange mount CA: 单耳环安装 /Male clevis CB: 双耳环安装 /Female clevis

※无牙轴心长度与内牙相同
Female thread and without thread have the same length of the piston rod.

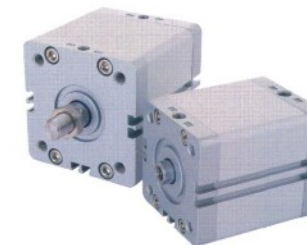

ADN ISO 21287

- Available in Bores 可选缸径
Φ12-16-20-25-32-40-50-63-80-100mm
- Kits available 可选购套件

标准型/Standard type

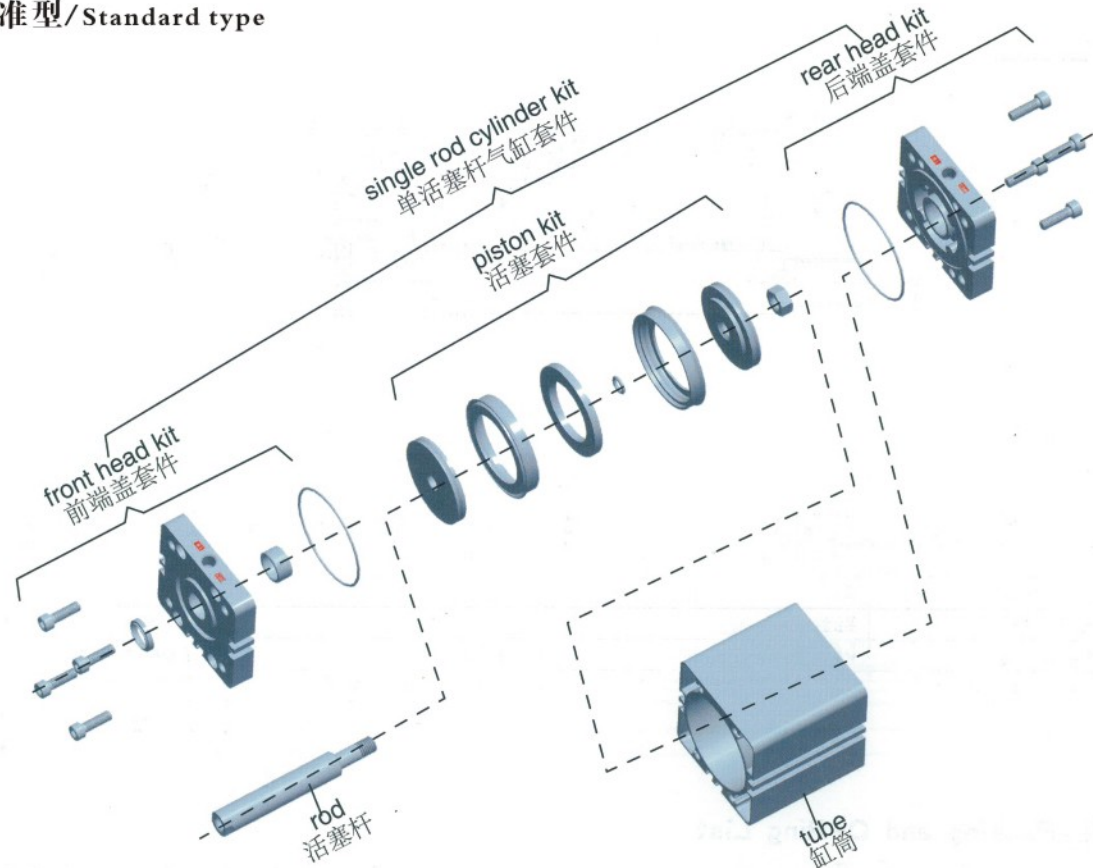

双轴型/Double shaft type

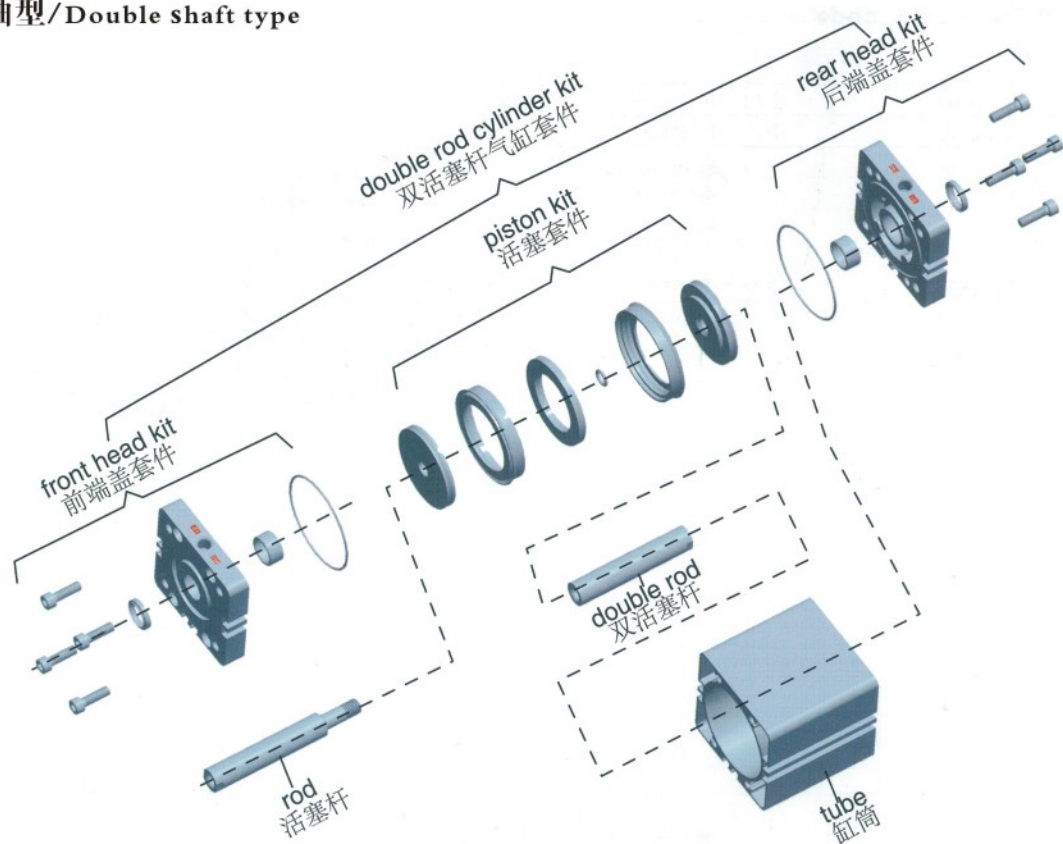

内部结构及主要零件材质/Inner structure and material list for main parts

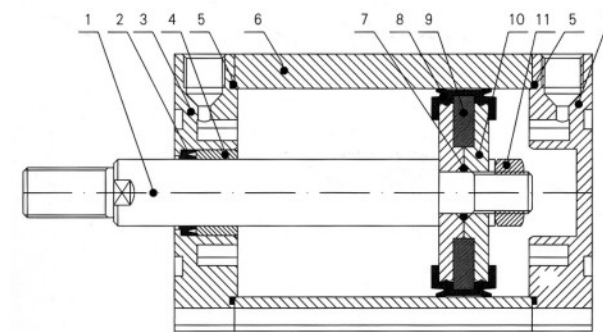

序号 No	名称 Name	材质 Material	序号 No	名称 Name	材质 Material
1	活塞杆 Piston rod	碳钢 Carbon steel	7	活塞杆O型圈 O-ring for piston rod	NBR
2	防尘圈 Anti dust seals	NBR	8	组合活塞圈 Piston ring	TPU
3	前端盖 Front cover	铝合金 Aluminium alloy	9	磁环 Magnet	铁氧体 Ferrite
4	含油轴承 Oil bearing	钢基粉末冶金 Sinterized bronze	10	活塞 Piston	铝合金 Aluminium alloy
5	管壁O型圈 O-ring for front cover	NBR	11	活塞杆螺帽 Nut for piston rod	碳钢 Carbon steel
6	缸筒 Tube	铝合金 Aluminium alloy	12	后端盖 Back cover	铝合金 Aluminium alloy

密封件/Packing and O-Ring List

规格 Item	防尘圈 Rod packing	端盖O型圈 Front cover O-Ring	活塞圈 Piston	磁环 Magnetic Ring	轴心圈 Piston O-Ring
直径 Bore size mm	数量No. 1	数量No. 2	数量No. 2	数量No. 1	数量No. 2
φ 12	EM-0609	φ 12* φ 9*1.5	GMP12*6*6	φ 10.5* φ 4*3	-
φ 16	EM-0811	φ 16* φ 13*1.5	GMP16*8*6	φ 14.5* φ 5*3	-
φ 20	EM-1014	φ 20* φ 17*1.5	GMP20*10*6	φ 18* φ 6*3	-
φ 25	EM-1014	φ 25* φ 22*1.5	GMP25*10*6	φ 23* φ 6*3	-
φ 32	EM-1214	φ 32* φ 29*1.5	GMP32*26*7	φ 29.5* φ 16*5	φ 11* φ 7*2
φ 40	EM-1214	φ 40* φ 37*1.5	GMP40*32*7.25	φ 37.5* φ 20*5	φ 11* φ 7*2
φ 50	EM-1620	φ 50* φ 47*1.5	GMP50*43*7.25	φ 46.5* φ 22*5	φ 13* φ 9*2
φ 63	EM-1620	φ 63* φ 59.4*1.8	GMP63*55*7.25	φ 59.5* φ 40*5	φ 13* φ 9*2
φ 80	EM-2025	φ 80* φ 75*2	GMP80*72*11	φ 76.5* φ 58*5	φ 18* φ 13*2.5
φ 100	EM-2025	φ 100* φ 96*2	GMP100*90*13	φ 96.5* φ 77*5	φ 18* φ 13*2.5

安装尺寸/Install dimension

Φ12~Φ25

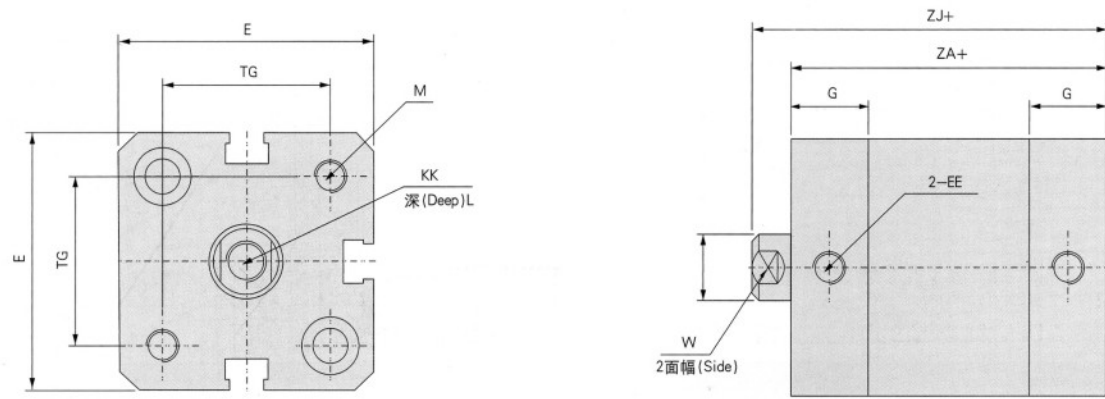

Φ32~Φ100

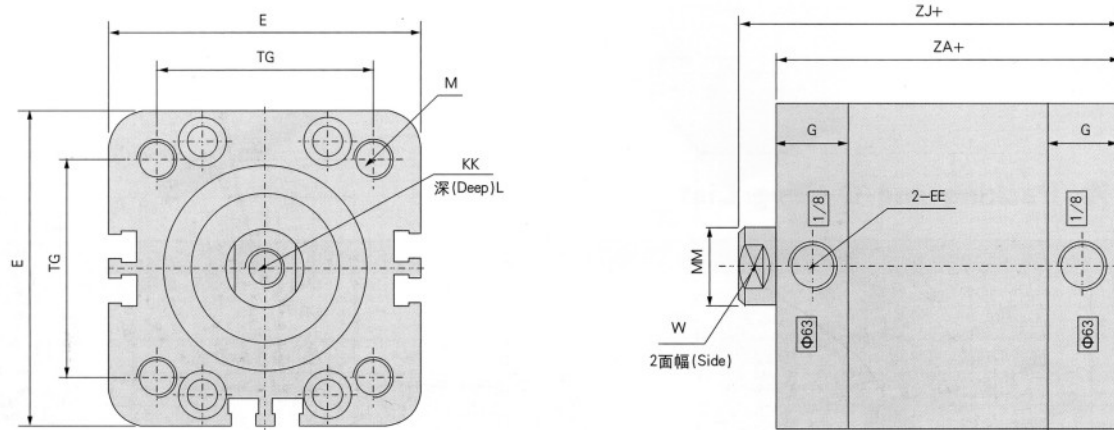

内径/符号(Bore/Symbol)	E	G	EE	MM	M	KK	L	TG	W	ZA	ZJ
12	27.5	10.5	M5	6	M4	M3	8	16	5	35	40
16	29	11	M5	8	M4	M4	10	18	7	35	40
20	35.5	12	M5	10	M5	M6	14	22	8	37	43
25	39.5	12	M5	10	M5	M6	14	26	8	39	45
32	47.5	15	G1/8	12	M6	M8	16	32.5	10	45	50
40	56.5	14.5	G1/8	12	M6	M8	16	38	10	45	51
50	66.5	14.5	G1/8	16	M8	M10	20	46.5	14	45	53
63	79.5	14.5	G1/8	16	M8	M10	20	56.5	14	50	57
80	100	16	G1/8	20	M10	M12	20	72	17	66	63
100	120	19.5	G1/4	20	M10	M12	20	89	17	67	76

外牙尺寸/Outer thread dimension

Φ12~Φ25

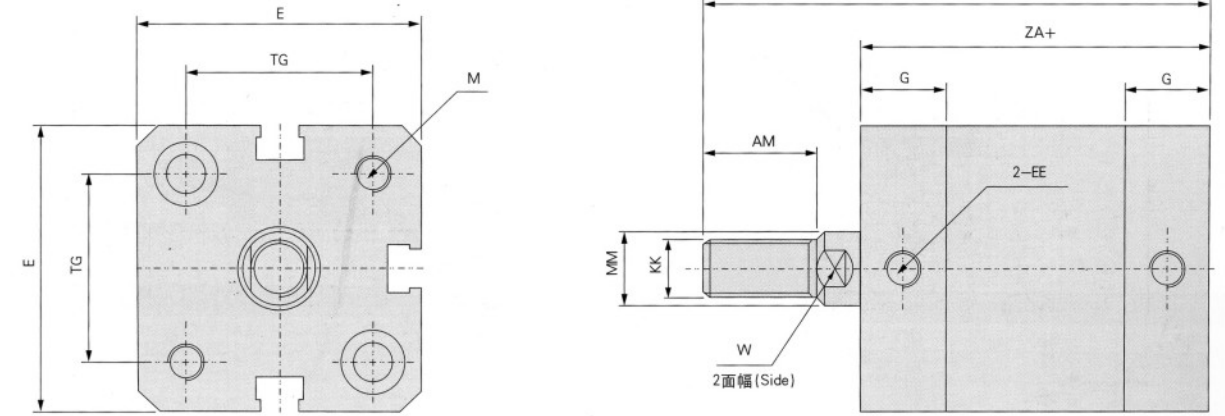

Φ32~Φ100

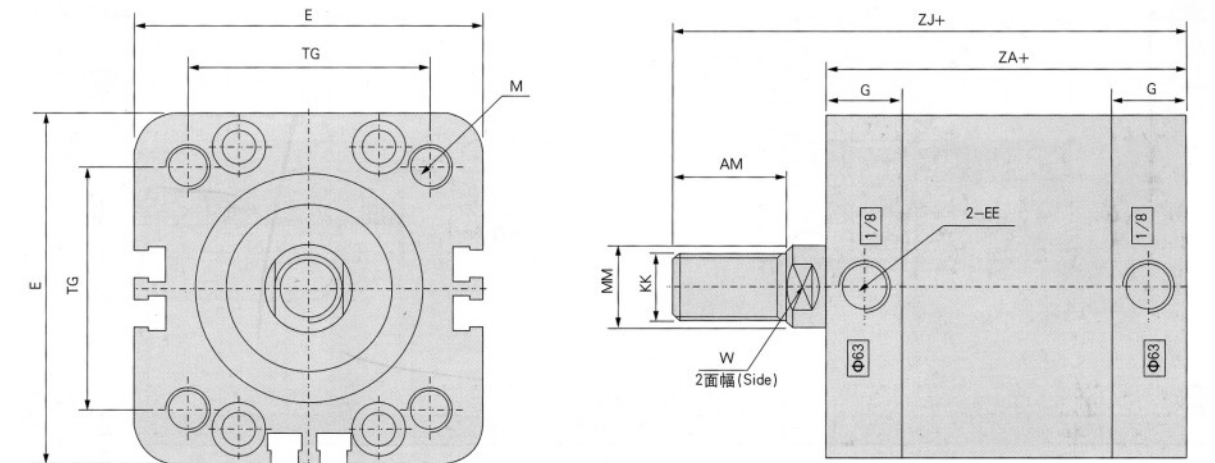

内径/符号(Bore/Symbol)	AM	E	G	EE	MM	M	KK	TG	W	ZA	ZJ
12	10	27.5	10.5	M5	6	M4	M5	16	5	35	40
16	12	29	11	M5	8	M4	M6	18	7	35	40
20	16	35.5	12	M5	10	M5	M8	22	8	37	43
25	16	39.5	12	M5	10	M5	M8	26	8	39	45
32	19	47.5	15	G1/8	12	M6	M10*1.25	32.5	10	45	50
40	19	56.5	14.5	G1/8	12	M6	M10*1.25	38	10	45	51
50	22	66.5	14.5	G1/8	16	M8	M12*1.25	46.5	14	45	53
63	22	79.5	14.5	G1/8	16	M8	M12*1.25	56.5	14	50	57
80	28	100	16	G1/8	20	M10	M16*1.5	72	17	66	63
100	28	120	19.5	G1/8	20	M10	M16*1.5	89	17	67	76

外牙尺寸/Outer Thread Dimension

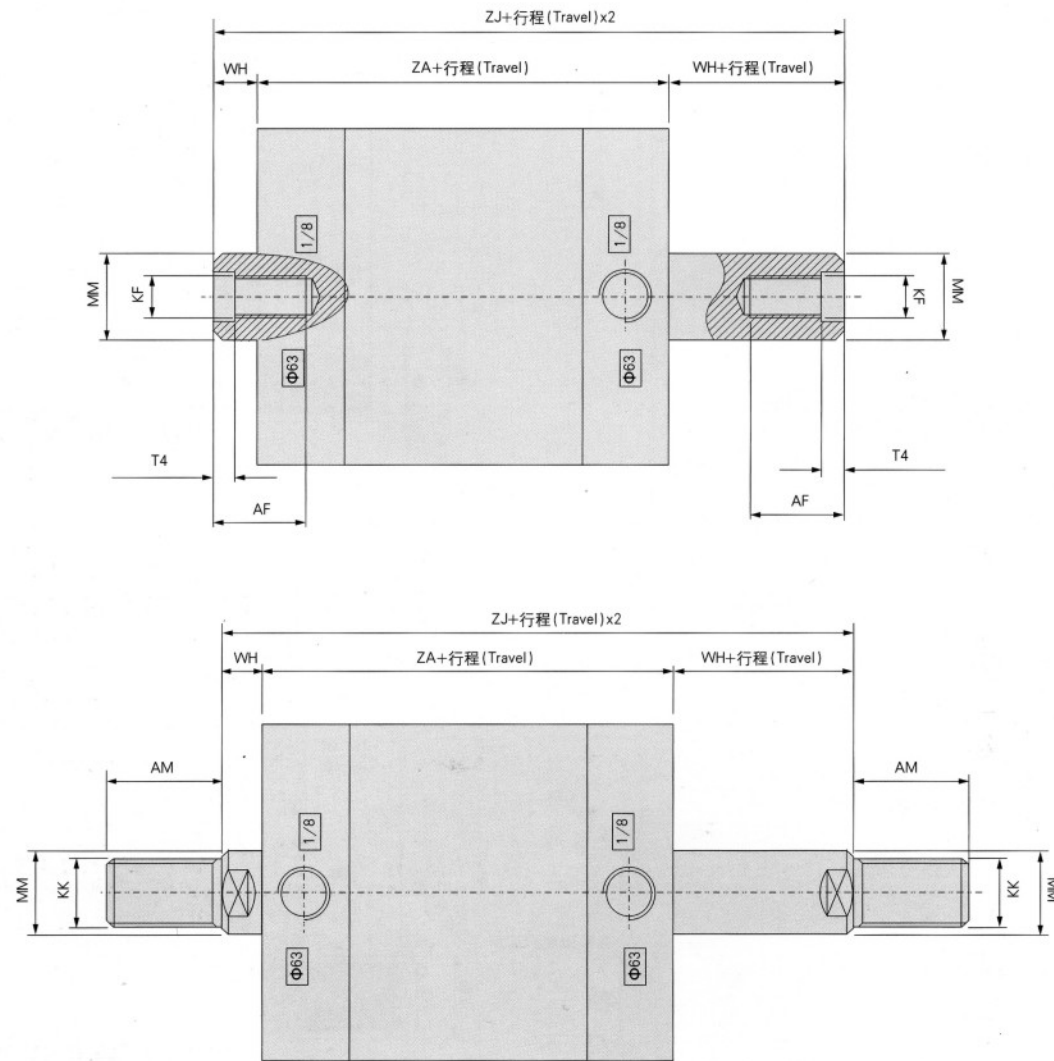

内径/符号(Bore/Symbol)	AF	AM	T4	MM	KF	KK	WH	ZA	ZJ
12	8	10	1.5	6	M3	M5	5	35	45
16	10	12	1.5	8	M4	M6	5	35	45
20	14	16	2.6	10	M6	M8	6	37	49
25	14	16	2.6	10	M6	M8	6	39	51
32	16	19	3.3	12	M8	M10*1.25	5	45	55
40	16	19	3.3	12	M8	M10*1.25	6	45	57
50	20	22	4.7	16	M10	M12*1.25	8	45	61
63	20	22	4.7	16	M10	M12*1.25	7	50	64
80	20	28	6.1	20	M12	M16*1.5	8	55	70
100	20	28	6.1	20	M12	M16*1.5	9	67	85

安装附件/Mounting kits

脚架安装件B-LB/Foot mount B-LB

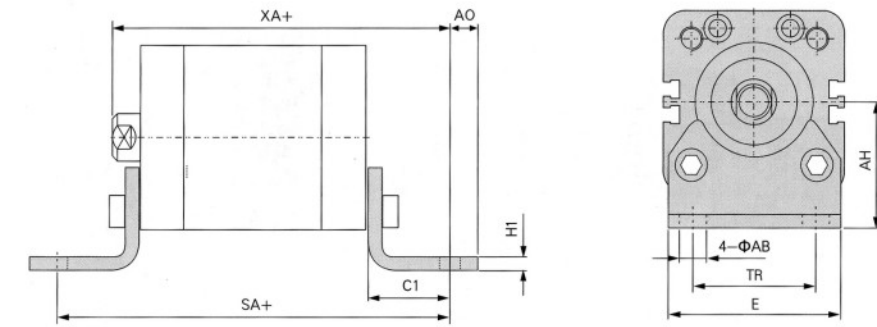

内径/符号(Bore/Symbol)	AB	AO	AH	C1	E	SA	TR	XA
12	5.8	5	21	13	26	61	16	53
16	5.8	4.75	22	13	27.5	61	18	53
20	7	6.25	27	16	34.5	69	22	59
25	7	6.25	29	16	38.5	71	26	61
32	7	7	33.5	16	46	77	32	66
40	10	9	38	18	55	81	36	69
50	10	8	45	21	65	87	45	74
63	10	8	50	21	78	92	50	78
80	12	10.5	63	26	100	107	63	89
100	14.5	12.5	74	27	120	121	75	103

前后法兰安装件B-FA/Front and rear flange mount B-FA

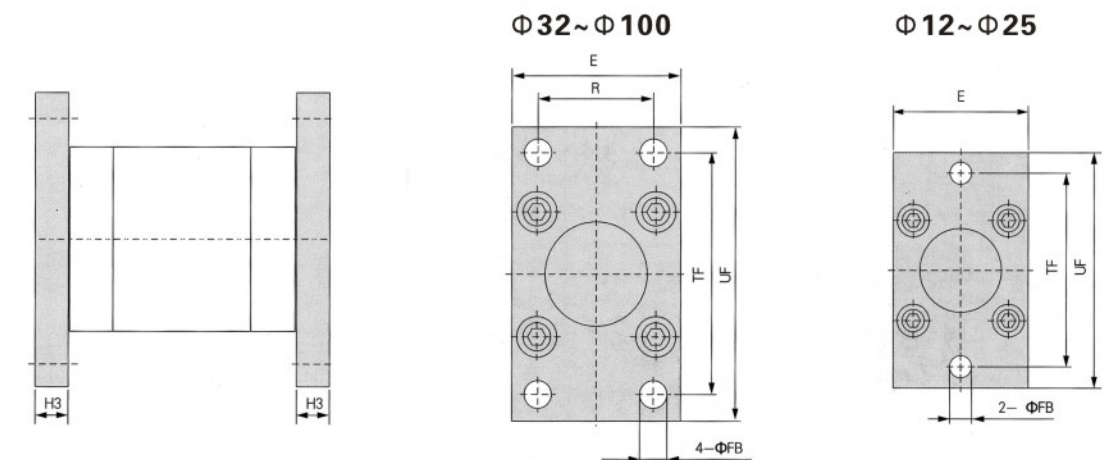

内径/符号(Bore/Symbol)	E	FB	H3	R	TF	UF
12	28	5.5	8	-	40	50
16	29	5.5	8	-	43	55
20	36	6.6	8	-	55	70
25	40	6.6	8	-	60	76
32	47	7	10	32	64	80
40	56	9	10	36	72	90
50	66	9	12	45	90	110
63	79	9	12	50	100	125
80	100	12	16	63	126	154
100	120	14	16	75	150	186

■ 安装附件/Mounting kits

单耳座/Male clevis B-CA

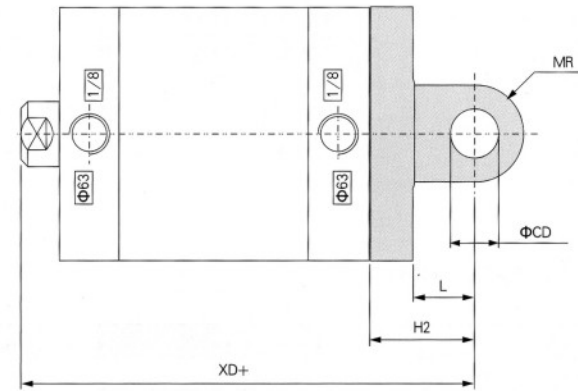
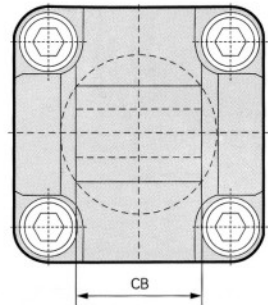

双耳座/Female clevis B-CB

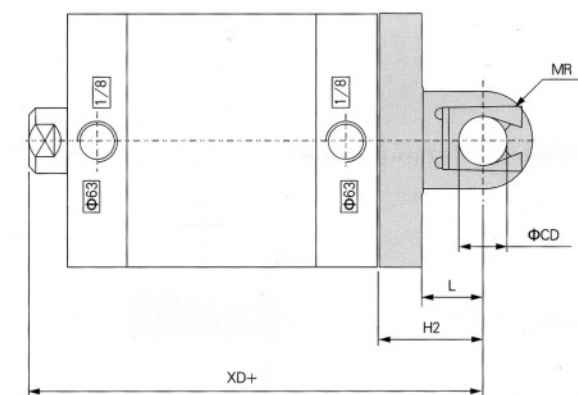
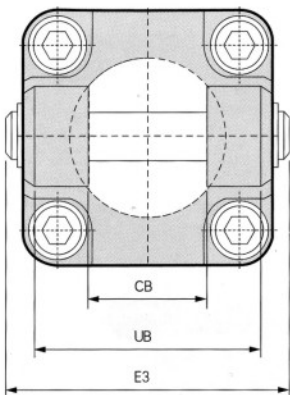

内径/符号(Bore/Symbol)	CB	CD	E3	H2	L	MR	UB	XD
32	26	10	55	22	13	10	45	72
40	28	12	63	25	16	12	52	76
50	32	12	71	27	16	12	60	80
63	40	16	83	32	21	16	70	89
80	50	16	103	36	22	16	90	99
100	60	20	127	41	27	20	110	117

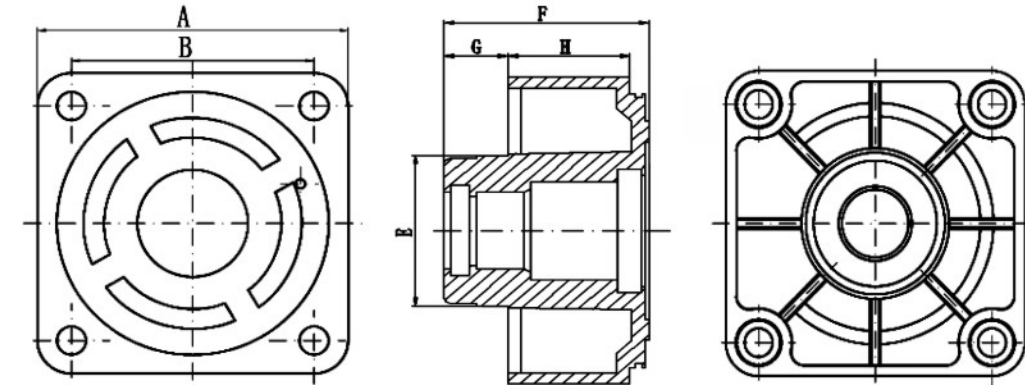

B-MB φ32-φ125端盖/Head						
规格/Sp. 代号/Code	A	B	E	F	G	H
φ32	46	32.5	30	46	13	27
φ40	52	38	35	46	13	27
φ50	65	46.5	40	51	14	31
φ63	75	56.5	45	51	14	31
φ80	95	72	45	64	20	38
φ100	114	89	55	64	20	38
φ125	138	110	60	74	27	40

■ 配件订购码/Kit Ordering Code

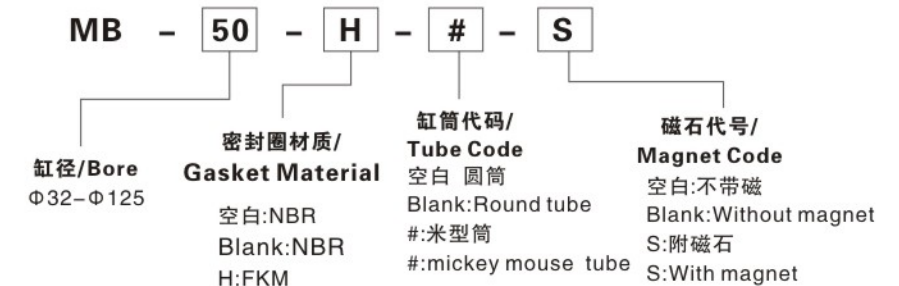

■ 规格/Specification

内径/Bore (mm)	32	40	50	63	80	100	125
普通高温使用温度范围/Available temperature °C	-10~250						
缓冲行程/Cushioning travel (mm)	24			30		25	
接管口径/Port size	G1/8	G1/4		G3/8		G1/2	

标准型/Standard type

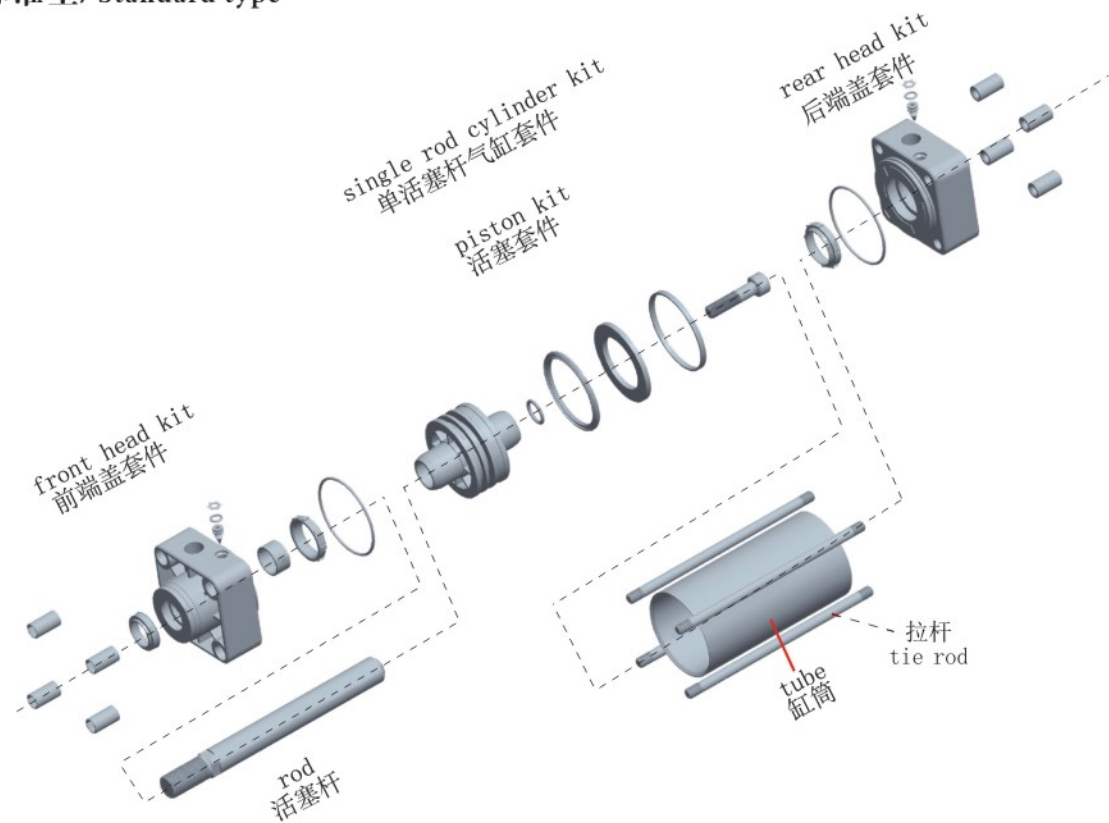

双轴型/Double shaft type

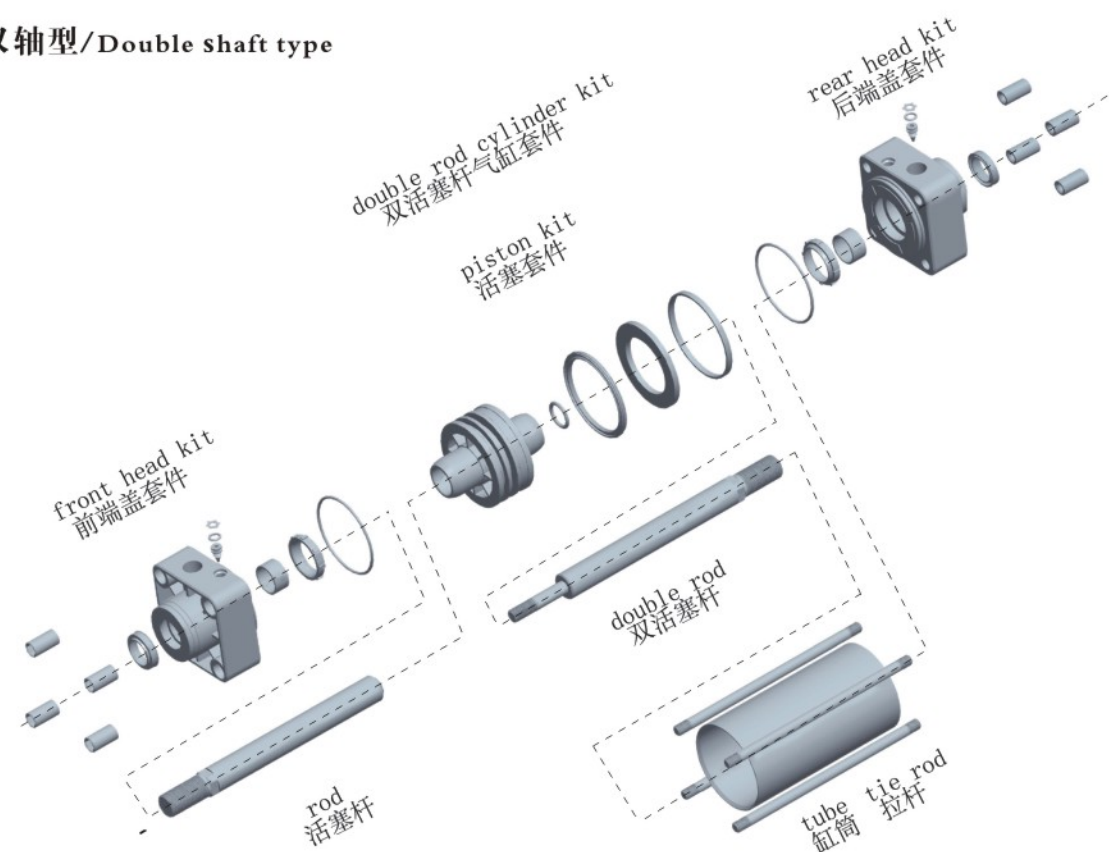

内部结构及主要零件材质/Inner structure and material list for main parts

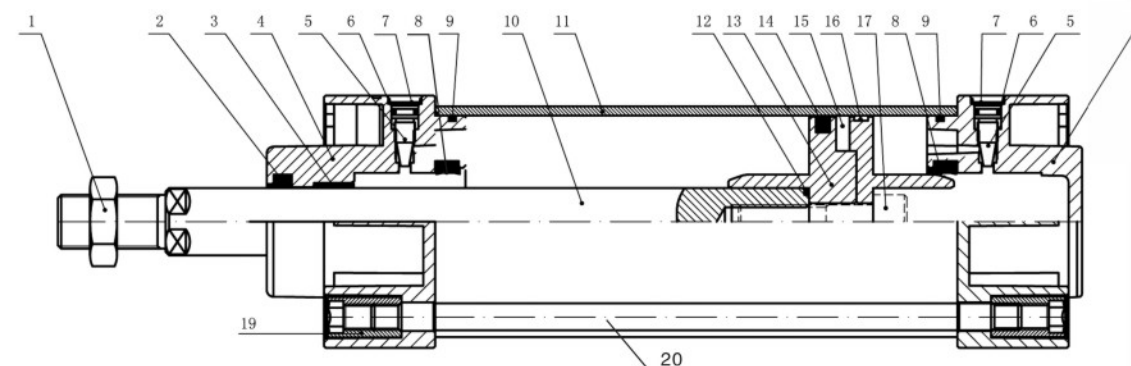

序号 No	名称 Name	材质 Material	序号 No	名称 Name	材质 Material
1	活塞杆螺帽 Nut for piston rod	碳钢 Carbon steel	11	缸筒 Tube	铝合金 Aluminium alloy
2	防尘圈 Anti dust seals	NBR	12	活塞杆O型圈 O-ring for piston rod	NBR
3	含油轴承 Oil bearing	钢基粉末合金 Sinterized bronze	13	活塞 Piston	铝合金 Aluminium alloy
4	前端盖 Front cover	铝合金 Aluminium alloy	14	活塞圈 Piston ring	NBR
5	针阀 Air cushioning screw	59铜 H59 brass	15	磁环 Magnet	铁氧体 Ferrite
6	针阀O型圈 O-ring for air cushioning screw	NBR	16	导向带 Wearing ring	POM
7	针阀卡环 Snap ring for air cushion hole screw	弹簧钢 Spring steel	17	活塞固定螺丝 Piston fixed screw	碳钢 Carbon steel
8	缓冲圈 Cushioning seals	NBR	18	后端盖 Back cover	铝合金 Aluminium alloy
9	管壁O型圈 O-ring for front cover	NBR	19	拉杆螺帽 Tie-rod nuts & screw	碳钢 Carbon steel
10	活塞杆 Piston rod	碳钢 Carbon steel	20	拉杆 Tie-rod	碳钢 Carbon steel

密封件/Packing and O-Ring List-单圈活塞/Single ring piston

规格 Item	防尘圈 Rod packing	缓冲圈 Cushion packing	端盖O型圈 End cover O-Ring	磁环 Magnetic Ring	单活塞圈 Single ring piston	轴心圈 Piston O-Ring	缓冲O型圈 Cushion O-Ring
数量No. Bore size mm	1	2	2	2	1	1	2
φ32	BDRP-12	BPP-1622	φ32※φ2	φ31.5※φ21※5	B-COP-32	φ12※φ2	φ8※φ1.5
φ40	BDRP-16	BPP-2028	φ40※φ2	φ39.5※φ24※5	B-COP-40	φ16※φ2	φ8※φ1.5
φ50	BDRP-20	BPP-2837	φ50※φ2	φ49.5※φ32※5	B-COP-50	φ20※φ2.4	φ8※φ1.5
φ63	BDRP-20	BPP-2837	φ63※φ2	φ62.5※φ42※5	B-COP-63	φ20※φ2.4	φ8※φ1.5
φ80	BDRP-25	BPP-3545	φ80※φ2	φ79.5※φ58※5	B-COP-80	φ25※φ2.4	φ8※φ1.5
φ100	BDRP-30	BPP-3545	φ100※φ2	φ99.5※φ78※5	B-COP-100	φ30※φ3.1	φ8※φ1.5
φ125	BDRP-32	BPP-4050	φ125※φ2	φ124.5※φ96※6	B-COP-125	φ32※φ3.1	φ12※φ1.5

基本尺寸/Basic specification

φ32~φ200

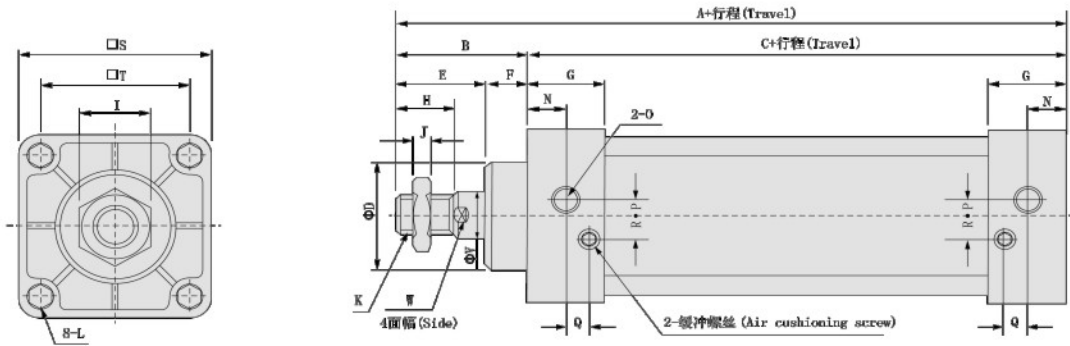

基本尺寸/Basic specification

φ32~φ200

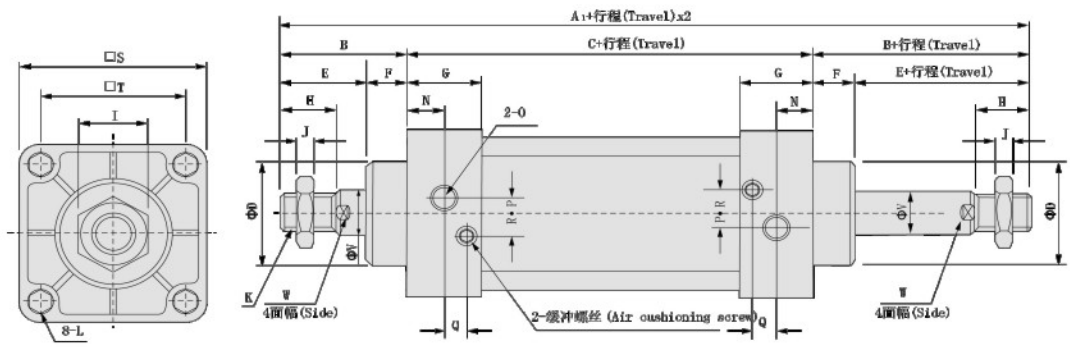

内径/符号 (Bore/Symbol)	A	A ₁	B	C	D	E	F	G	H	I	J	K	L
32	131	178	47	84	30	34	13	27	22	17	6	M10×1.25	M6
40	135	186	51	84	35	38	13	27	30	19	7	M14×1.5	M6
50	152	210	58	94	40	44	14	31	35	24	8	M18×1.5	M8
63	152	210	58	94	45	44	14	31	35	24	8	M18×1.5	M8
80	186	258	72	114	45	52	20	38	40	30	10	M22×1.5	M10
100	186	258	72	114	55	52	20	38	40	30	10	M26×1.5	M10
125	217	304	97	120	60	74	25	40	54	41	13.5	M27×2	M12

内径/符号 (Bore/Symbol)	N	O	P	Q	R	S	T	V	W
32	13	G1/8	4	6.7	6.5	46	32.5	12	10
40	14	G1/4	4	7	9	52	38	16	13
50	15.5	G1/4	5	8.7	10.5	65	46.5	20	17
63	15.5	G3/8	9	8.8	12	75	56.5	20	17
80	19	G3/8	11.5	11.5	14	95	72	25	22
100	19	G1/2	17	10	15	114	89	30	26
125	23	G1/2	14	12	14	140	110	32	27

安装附件/Mounting kits

B-LB型尺寸/B-LB Size

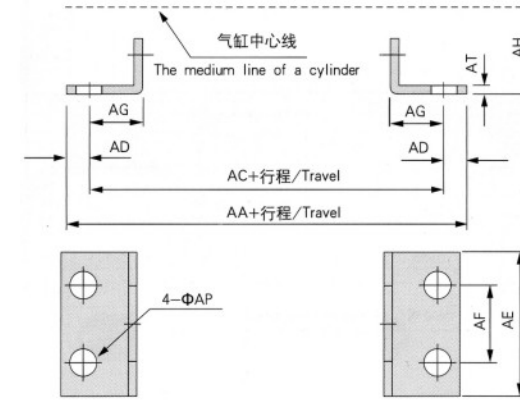

符号/内径(Symbol/Bore)	32	40	50	63	80	100	125
AA	146	154	170	176	202	210	250
AC	128	132	148	148	174	178	210
AD	9	11	11	14	14	16	20
AE	50	55	70	80	100	120	140
AF	32	38	46	56	72	89	90
AG	22	24	27	27	30	32	45
AH	30	33	40	45	55	65	81
AP	7	9	9	12	12	14	16
AT	3.2	3.2	3.2	3.6	4.5	4.5	8

B-FA型尺寸/B-FA Size
B-FB型尺寸/B-FB Size

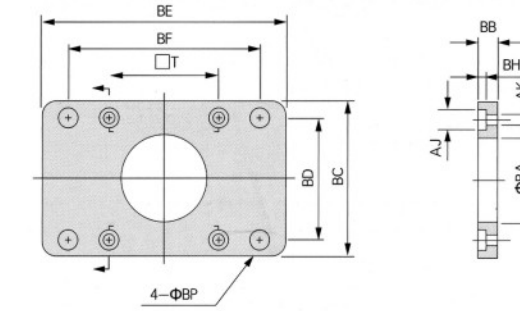

符号/内径(Symbol/Bore)	32	40	50	63	80	100	125
AJ	11	11	14	14	17.5	17.5	19
QK	7	7	7	9	10.5	10.5	13
BA	31	36	41	46	46	56	61
BB	10	10	12	12	16	16	20
BC	50	55	70	80	100	120	140
BD	32	36	45	50	63	75	110
BE	79	90	110	120	153	178	224
BF	64	72	90	100	126	150	180
BH	6.5	6.5	8.5	8.5	10.5	10.5	12.5
BP	7	9	9	9	12	14	16
T□	32.5	38	46.5	56.5	72	89	110

B-CA型尺寸/B-CA Size

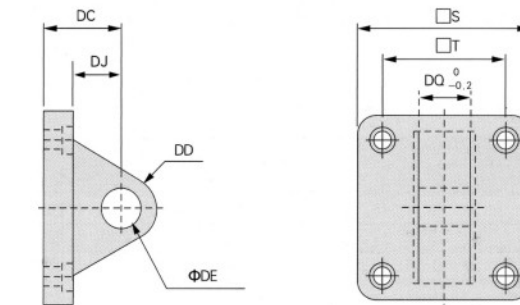

符号/内径(Symbol/Bore)	32	40	50	63	80	100	125
S	46	52	65	75	95	114	140
T	32.5	38	46.5	56.5	72	89	110
DC	23	23	30	30	42	42	50
DD	10	11	15	15	23	23	25
DE	10	10	14	14	22	22	25
DJ	13	13	17	17	26	26	33
DQ	14	14	20	20	30	30	69.7

安装附件/Mounting kits

B-CB型尺寸/B-CB Size

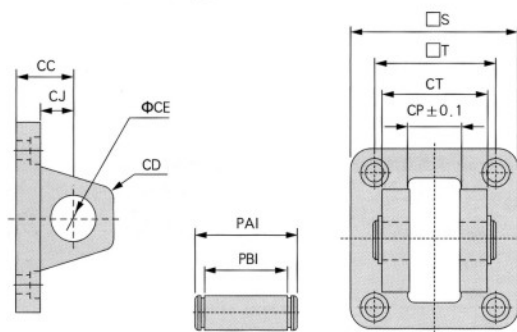

符号/内径(Symbol/Bore)	32	40	50	63	80	100	125
CC	23	23	30	130	42	42	50
CD	10	11	15	15	23	23	8
CE	10	10	14	14	22	22	25
CJ	13	13	17	17	26	26	31
CP	14	14	20	20	30	30	70
CT	28	28	40	40	60	60	130
PAI	35	36	48	48	69	69	139
PBI	29	29	41	41	61	61	131
S	46	52	65	75	95	114	140
T	32.5	38	46.5	56.5	72	89	110

B-TC型尺寸/B-TC Size

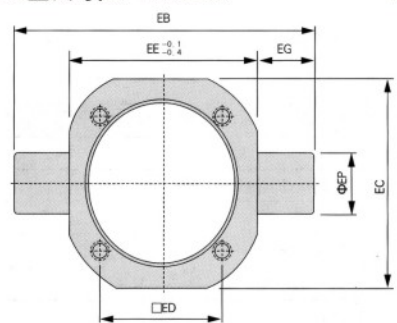

B-MB系列用/Use for B-MB series

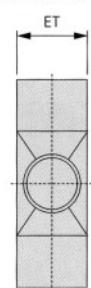

B-MBU系列用/Use for B-MBU series

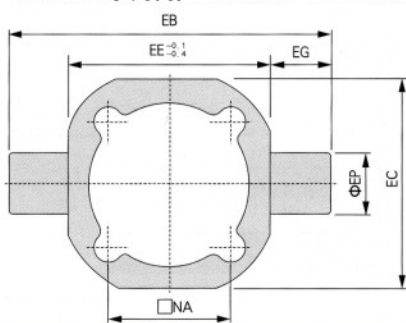

符号/内径(Symbol/Bore)	32	40	50	63	80	100	125
EB	74	95	107	130	150	182	210
EC	49	58	71	87	110	136	163
ED	32.5	38	46.5	56.5	72	89	110
EE	50	63	75	90	110	132	160
EG	12	17	17	20	20	25	25
EP	12	16	16	20	20	25	25
ET	17	22	22	28	34	40	45

B-TC-M型/B-TC-M Type

B-MBU系列用/Use for B-MBU series

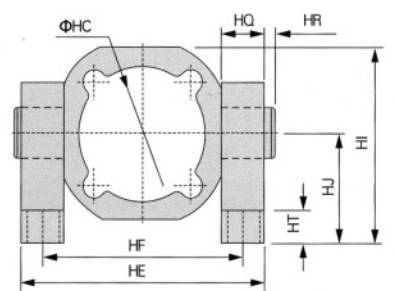

B-TC-M系列用/Use for B-TC-M series

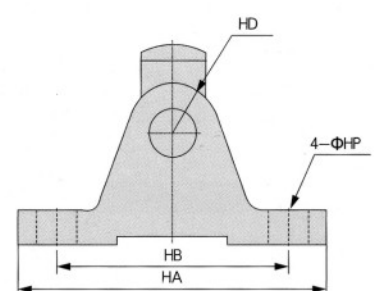

B-MB系列用/Use for B-MB series

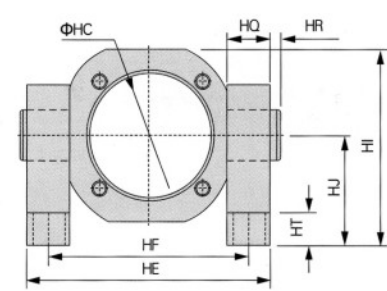

符号/内径 (Symbol/Bore)	32	40	50	63	80	100	125
HA	63	80	80	100	100	120	145
HB	45	60	60	70	70	90	105
HD	12	16	16	20	20	25	25
HE	74	96	107	130	150	180	210
HF	62	79	91	110	130	155	185
HI	60	74	80	103	115	143	166

符号/内径 (Symbol/Bore)	32	40	50	63	80	100	125
HJ	35	45	45	60	60	75	85
HQ	12	17	17	20	20	25	25
HR	0	1	1	1	1	1	1
HT	10	12	12	14	14	17	25
HP	7	9	9	11	11	14	18

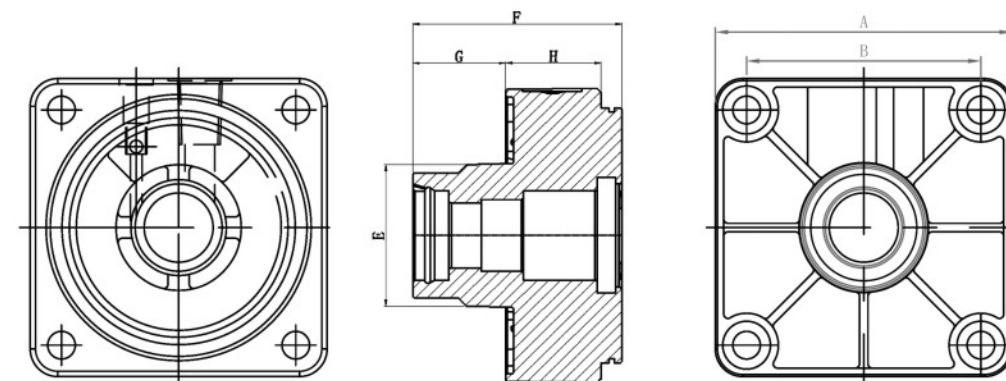

B-SI φ32-φ200端盖/Head						
规格/Sp. 代号/Code	A	B	E	F	G	H
φ32	47	32.5	φ30	52	19	27.5
φ40	53	38	φ35	58.5	21	32
φ50	65	46.5	φ40	66.5	27	31
φ63	75	56.5	φ45	69	27	33
φ80	95	72	φ45	81.5	33	33
φ100	115	89	φ55	85	36	37
φ125	140	110	φ60	100	40	45
φ160	180	140	φ65	120	55	50
φ200	220	175	φ75	131	67	50

配件订购码/Kit Ordering Code

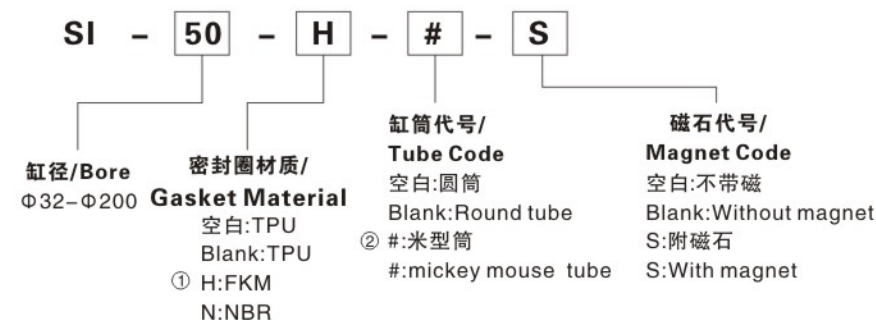

注: ① φ32-φ125高温防尘圈是EU, φ160-φ200高温防尘圈是DRP, ② #米型筒直径最大200。

Remark: ① φ32-φ125 high temperature anti dust wiper, φ160-φ250 high temperature anti dust wiper. ② # mickey mouse tube maximum diameter 200.

标准型/Standard type

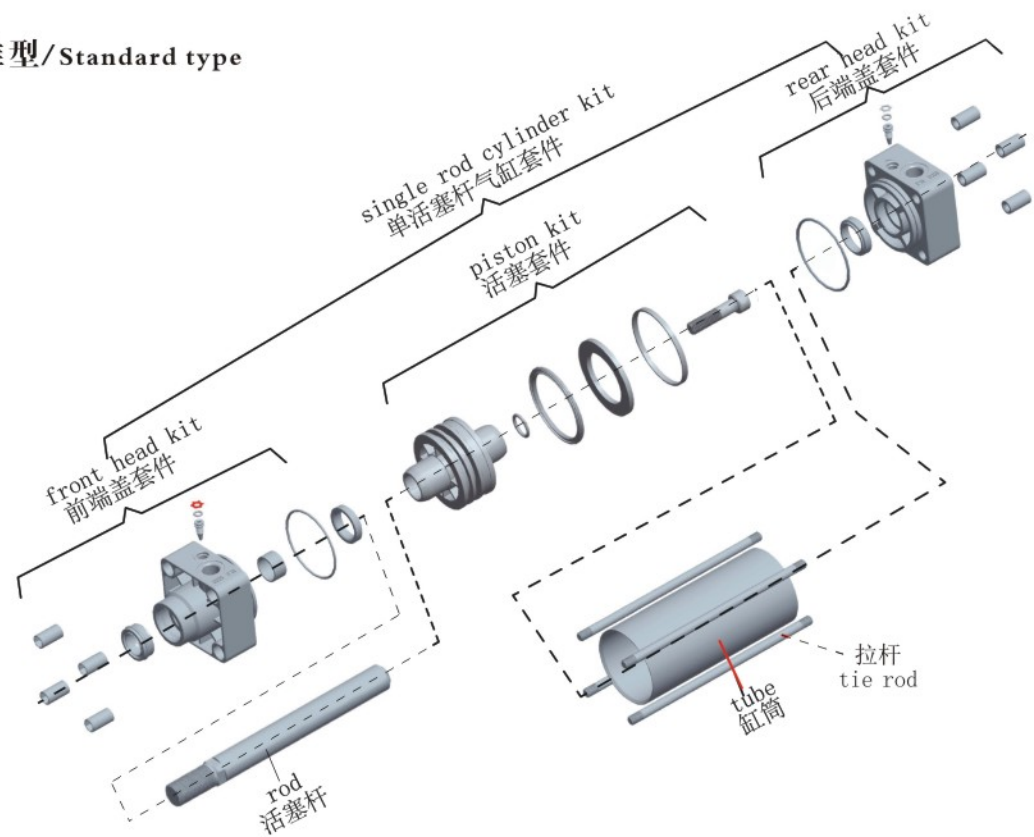

双轴型/Double shaft type

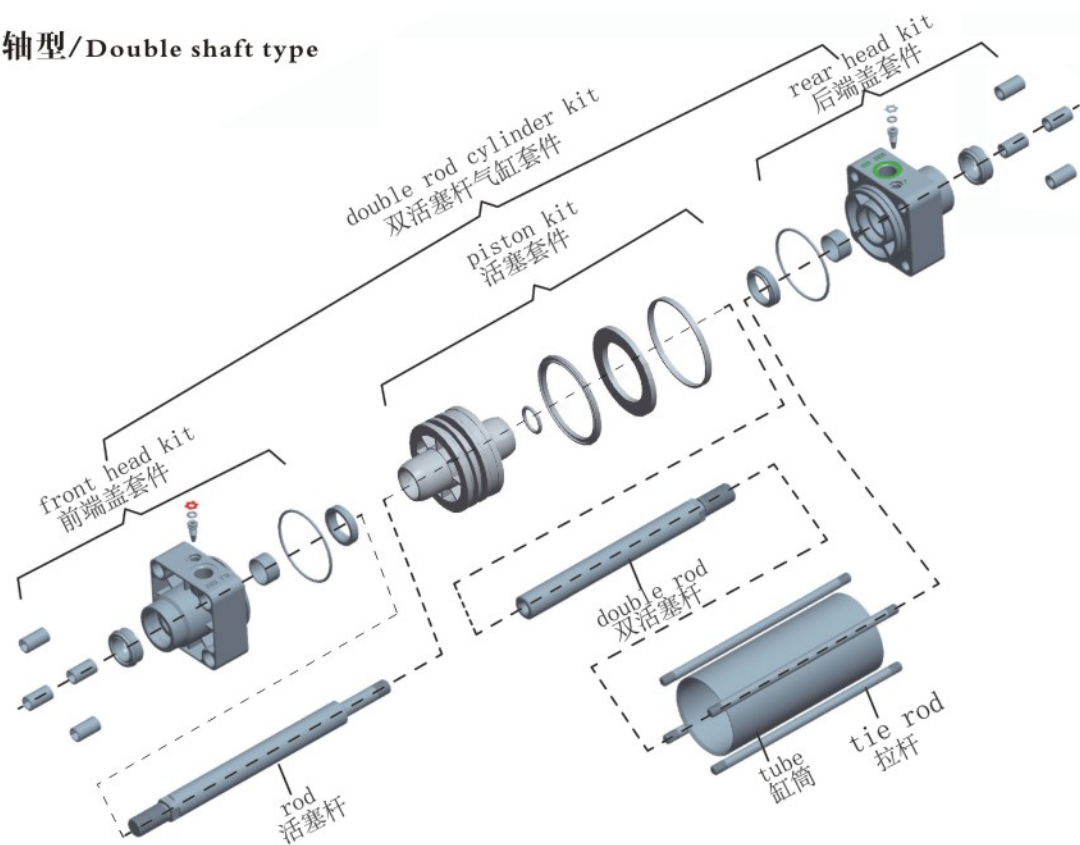

内部结构及主要零件材质/Inner structure and material list for main parts

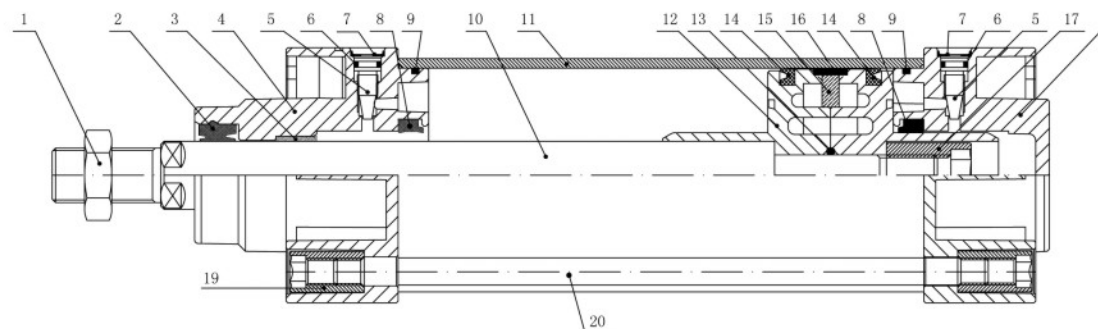

序号 No	名称 Name	材质 Material	序号 No	名称 Name	材质 Material
1	活塞杆螺帽 Nut for piston rod	碳钢 Carbon steel	11	缸筒 Tube	铝合金 Aluminium alloy
2	防尘圈 Anti dust seals	PU	12	活塞 Piston	铝合金 Aluminium alloy
3	含油轴承 Oil bearing	钢基粉末合金 Sinterized bronze	13	轴芯垫 O-ring for piston and piston rod	NBR
4	前端盖 Front cover	铝合金 Aluminium alloy	14	活塞圈 Piston ring	NBR
5	针阀 Air cushioning screw	59铜 H59 brass	15	磁环 Magnet	铁氧体 Ferrite
6	针阀O型圈 O-ring for air cushioning screw	NBR	16	导向带 Wearing ring	POM
7	针阀卡环 Snap ring for air cushion hole screw	弹簧钢 Spring steel	17	活塞固定螺帽 Nut for piston and piston rod fixed	碳钢 Carbon steel
8	缓冲圈 Cushioning seals	NBR	18	后端盖 Back cover	铝合金 Aluminium alloy
9	管壁O型圈 O-ring for front cover	NBR	19	拉杆螺丝 Tie-rod nuts & screw	碳钢 Carbon steel
10	活塞杆 Piston rod	碳钢 Carbon steel	20	拉杆 Tie-rod	碳钢 Carbon steel

密封件/Packing and O-Ring List

规格 item	防尘圈 Rod packing	缓冲圈 Cushion packing	端盖O型圈 End cover O-Ring	磁环 Magnetic Ring	活塞圈 Piston	轴心圈 Piston O-Ring	缓冲O型圈 Cushion O-Ring
直径 Bore size mm	数量No. 1	2	2	2	2	1	2
φ 32	BEU-1219	BPP-1622	φ 32※ φ 2	φ 28※ φ 16※5	B-QZ8-3224	φ 12※ φ 2	φ 8※ φ 1.5
φ 40	BEU-1626	BPP-2028	φ 40※ φ 2	φ 36※ φ 20※5	B-QZ8-4032	φ 16※ φ 2.4	φ 8※ φ 1.5
φ 50	BEU-2030	BPP-2837	φ 50※ φ 2	φ 46※ φ 22※5	B-QGP-5042	φ 20※ φ 2.4	φ 8※ φ 1.5
φ 63	BEU-2030	BPP-2837	φ 63※ φ 2	φ 59※ φ 40※5	B-QGP-6353	φ 20※ φ 2.4	φ 8※ φ 1.5
φ 80	BEU-2535	BPP-3545	φ 80※ φ 2	φ 76※ φ 58※5	B-QGP-8070	φ 25※ φ 2.4	φ 8※ φ 1.5
φ 100	BEU-2535	BPP-3545	φ 100※ φ 2	φ 96※ φ 77※5	B-QGP-10090	φ 25※ φ 2.4	φ 8※ φ 1.5
φ 125	BEU-3242	BPP-4050	φ 125※ φ 3.5	φ 120※ φ 96※6	B-QGP φ 113※7	φ 32※ φ 3.1	φ 12※ φ 1.5
φ 160	BEU-4050 BB3-4048	BPP-5060	φ 160※ φ 4	φ 155※ φ 131.5※6	B-QGP φ 145※9.5	φ 40※ φ 3.1	φ 12※ φ 1.5
φ 200	BEU-4050 BB3-4048	BPP-5060	φ 200※ φ 4	φ 195※ φ 172※6	B-QZ8 φ 180※ φ 8.5	φ 40※ φ 3.1	φ 12※ φ 1.5

外部规格/Overall dimension

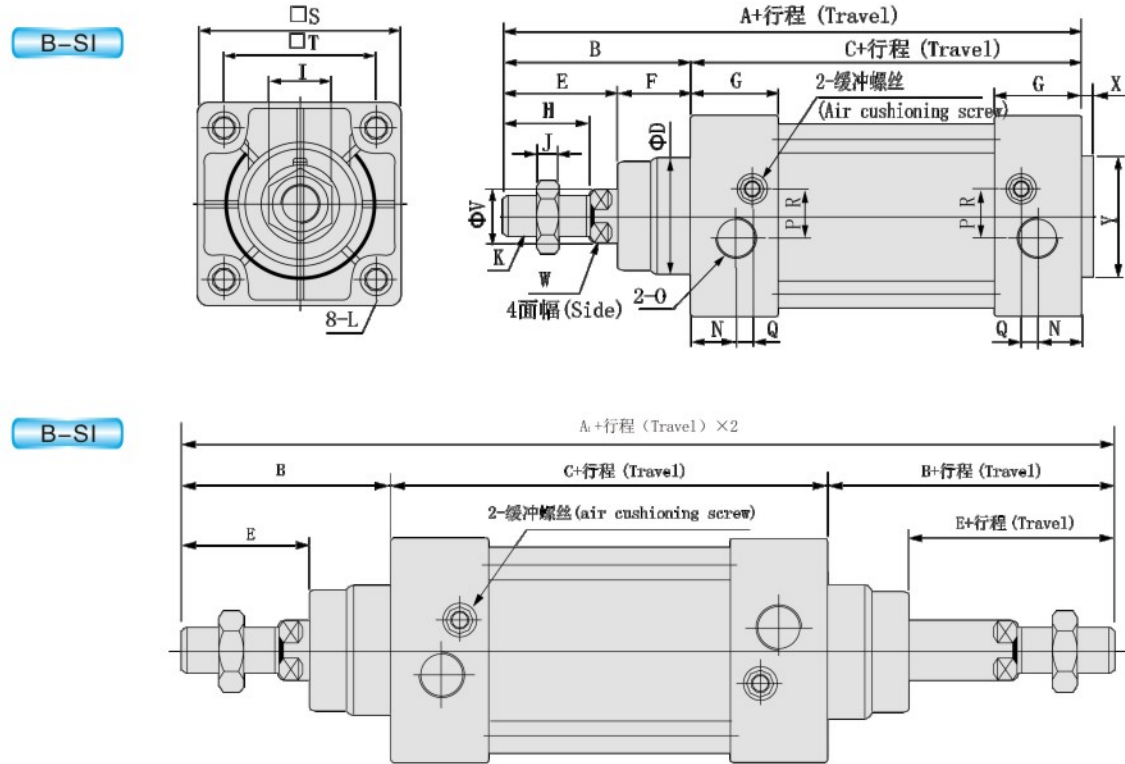

内径/符号 (Bore/Symbol)	A	A ₁	B	C	D	E	F	G	H	I	J	K	L	N
32	142	190	48	94	30	29	19	27	22	17	6	M10×1.25	M6	13
40	159	213	54	105	35	33	21	31	24	17	7	M12×1.25	M6	17
50	175	244	69	106	40	42	27	31	32	23	8	M16×1.5	M8	15.5
63	190	259	69	121	45	42	27	33	32	23	8	M16×1.5	M8	16.5
80	214	300	86	128	45	53	33	33	40	26	10	M20×1.5	M10	16.5
100	229	320	91	138	55	55	36	37	40	26	10	M20×1.5	M10	18.5
125	279	398	119	160	60	79	40	45	54	41	13.5	M27×2	M12	23
160	332	484	152	180	65	94	55	50	72	55	18	M36×2	M16	25
200	347	514	167	180	75	100	67	50	72	55	18	M36×2	M16	25

内径/符号 (Bore/Symbol)	O	P	Q	R	S	T	V	W	X	Y
32	G1/8	5.5	6	6	47	32.5	12	10	3	30
40	G1/4	6	7.5	8.5	53	38	16	13	3.5	35
50	G1/4	7.5	6.5	9.5	65	46.5	20	17	3.5	40
63	G3/8	7.5	7.5	11.5	75	56.5	20	17	4	45
80	G3/8	9	7.5	13.5	95	72	25	22	4	45
100	G1/2	9.5	8.5	13.5	115	89	25	22	4	55
125	G1/2	14	12	14	140	110	32	27	4	60
160	G3/4	15	12	15	180	140	40	36	4	65
200	G3/4	15	12	20	220	175	40	36	5	75

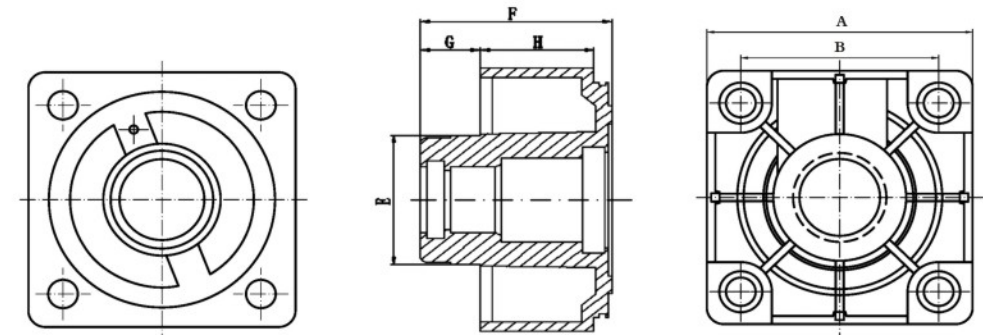

B-SC φ32-φ250端盖/Head						
规格/Spec. 代号/Code	A	B	E	F	G	H
φ32	45	33	φ28	48.5	15	27.5
φ40	50	37	φ32	48.5	15	27.5
φ50	62	47	φ38	48.5	15	27.5
φ63	75	56	φ38	48.5	15	27.5
φ80	94	70	φ47	60	21	33
φ100	112	84	φ47	60	21	33
φ125	138	104	φ52	64.5	20	38
φ160	174	134	φ62	70.5	25	38
φ200	214	163	φ62	70.5	30	38
φ250	267	202	φ86	93	35	48

配件订购码/Kit Ordering Code

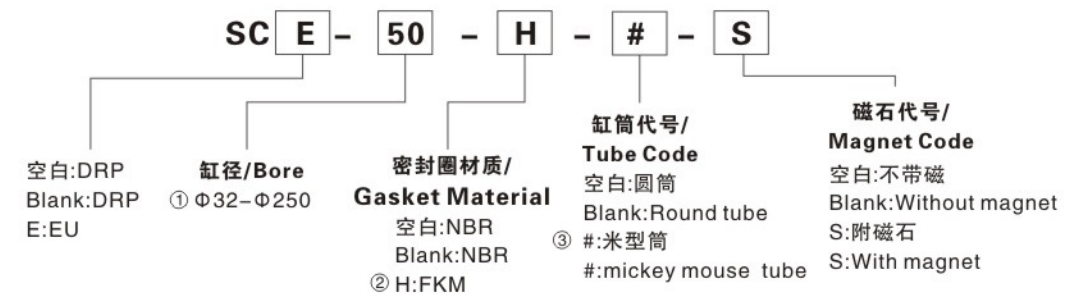

注: ① φ200, φ250为低压铸件。
② SCE高温EU防尘只限于 φ32-φ100。
③ #米型筒直径最大100。
Remark:
① φ200, φ250 low pressure casting.
② SCE Available for φ32-φ100 only
③ # mickey mouse maximum diameter 100.

标准型/Standard type

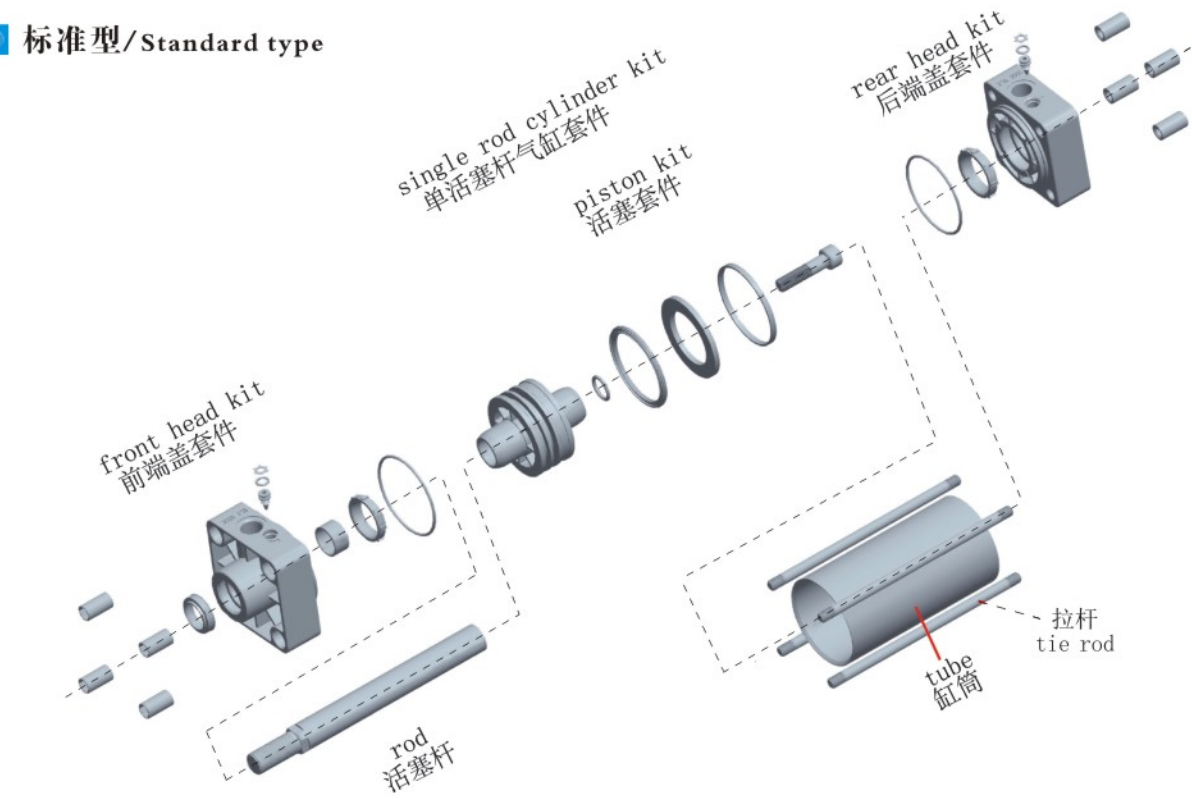

双轴型/Double shaft type

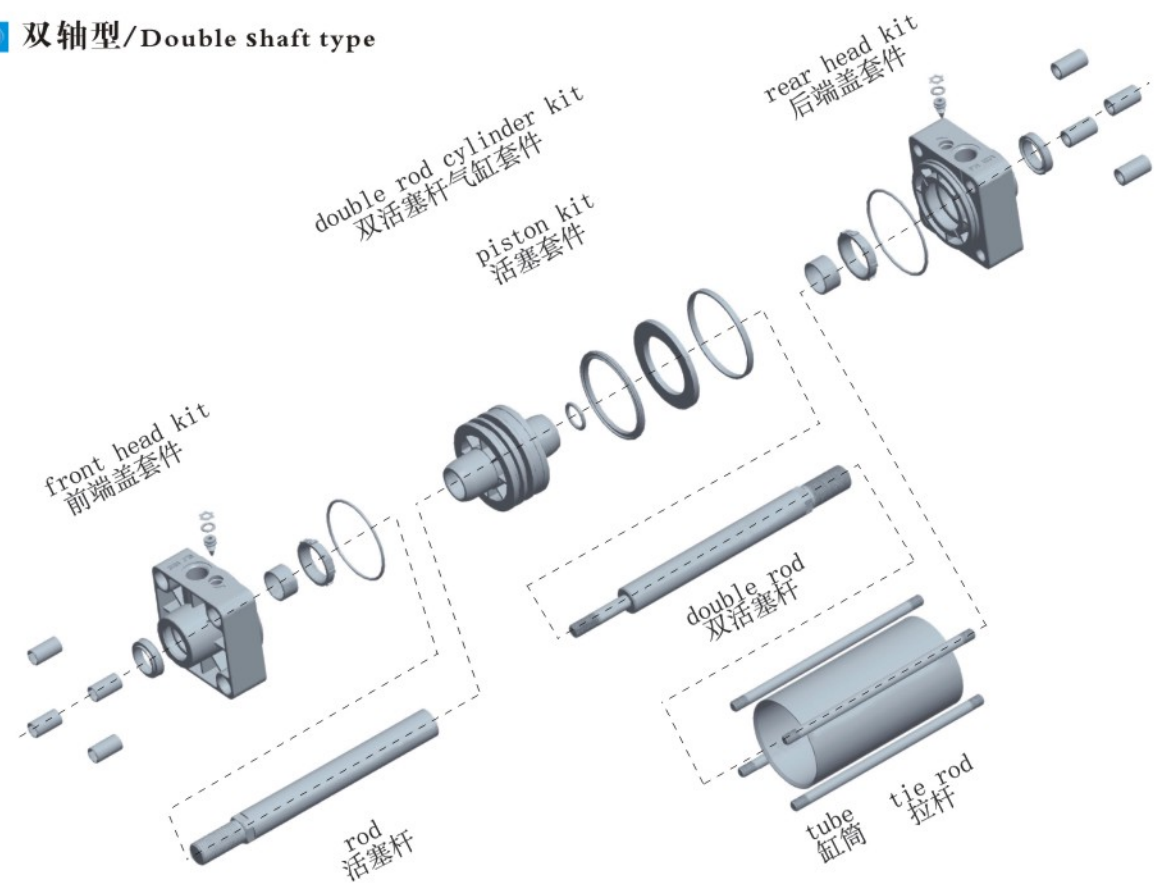

内部结构及主要零件材质/Inner structure and material list for main parts

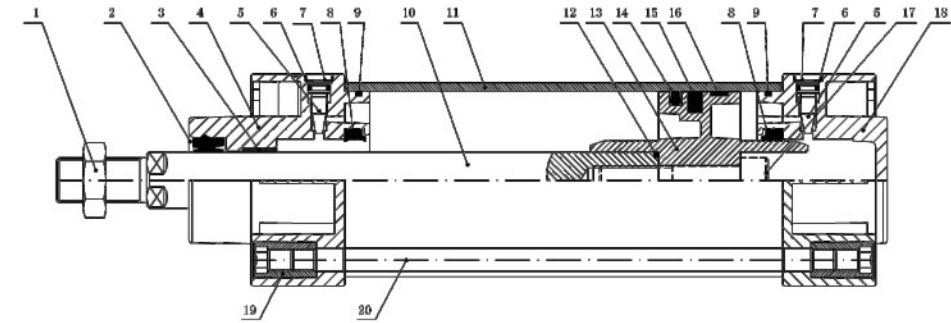

序号 No	名称 Name	材质 Material	序号 No	名称 Name	材质 Material
1	活塞杆螺帽 Nut for piston rod	碳钢 Carbon steel	11	缸筒 Tube	铝合金 Aluminium alloy
2	防尘圈 Anti dust seals	PU	12	活塞杆O型圈 O-ring for piston rod	NBR
3	含油轴承 Oil bearing	钢基粉末合金 Sinterized bronze	13	活塞 Piston	铝合金 Aluminium alloy
4	前端盖 Front cover	铝合金 Aluminium alloy	14	活塞圈 Piston ring	NBR
5	针阀 Air cushioning screw	黄铜 Brass	15	磁环 Magnet	铁氧体 Ferrite
6	针阀O型圈 O-ring for air cushioning screw	NBR	16	导向带 Wearing ring	POM
7	针阀卡环 Snap ring for air cushion hole screw	弹簧钢 Spring steel	17	活塞固定螺丝 Piston fixing screw	碳钢 Carbon steel
8	缓冲圈 Cushioning seals	NBR	18	后端盖 Back cover	铝合金 Aluminium alloy
9	管壁O型圈 O-ring for front cover	NBR	19	拉杆螺帽 Tie-rod nuts & screw	碳钢 Carbon steel
10	活塞杆 Piston rod	碳钢 Carbon steel	20	拉杆 Tie rod	碳钢 Carbon steel

密封件/Packing and O-Ring List-单圈活塞/Single ring piston

规格 Item	防尘圈 Rod packing	缓冲圈 Cushion packing	端盖O型圈 End cover O-Ring	磁环 Magnetic Ring	单活塞圈 Single ring piston	轴心圈 Piston O-Ring	缓冲O型圈 Cushion O-Ring
直径 Bore size mm	数量No. 1	数量No. 2	数量No. 2	数量No. 2	数量No. 1	数量No. 1	数量No. 2
φ 32	BDRP-12	BPP-1622	φ 32※ φ 2	φ 31.5※ φ 24.5※5	B-COP-32	φ 12※ φ 2	φ 8※ φ 1.5
φ 40	BDRP-16	BPP-2028	φ 40※ φ 2	φ 39.5※ φ 25※5	B-COP-40	φ 16※ φ 2.4	φ 8※ φ 1.5
φ 50	BDRP-20	BPP-2837	φ 50※ φ 2	φ 49.5※ φ 35※5	B-COP-50	φ 20※ φ 2.4	φ 8※ φ 1.5
φ 63	BDRP-20	BPP-2837	φ 63※ φ 2	φ 62.5※ φ 48※5	B-COP-63	φ 20※ φ 2.4	φ 8※ φ 1.5
φ 80	BDRP-25	BPP-3545	φ 80※ φ 2	φ 79.5※ φ 65※5	B-COP-80	φ 25※ φ 2.4	φ 8※ φ 1.5
φ 100	BDRP-25	BPP-3545	φ 100※ φ 2	φ 99.5※ φ 85※5	B-COP-100	φ 25※ φ 2.4	φ 8※ φ 1.5
φ 125	BDRP-32	BPP-4050	φ 125※ φ 2.4	φ 120※ φ 96※6	B-COP-125	φ 32※ φ 3.1	φ 12※ φ 1.5
φ 160	BDRP-40	BPP-5060	φ 160※ φ 3.1	φ 155※ φ 131.5※6	B-COP-160	φ 40※ φ 3.1	φ 12※ φ 1.5
φ 200	BDRP-40	BPP-5060	φ 200※ φ 3.1	φ 195※ φ 172※6	B-COP-200	φ 40※ φ 3.1	φ 12※ φ 1.5
φ 250	BDRP-50	BPP-5774	φ 250※ φ 3.1	φ 245※ φ 222※6	B-COP-250	φ 50※ φ 3.1	φ 16※ φ 1.5

密封件/Packing and O-Ring List-双圈活塞/Double ring piston

规格 Item	防尘圈 Rod packing	缓冲圈 Cushion packing	端盖O型圈 End cover O-Ring	磁环 Magnetic Ring	双活塞圈 Double ring piston	轴心圈 Piston O-Ring	缓冲O型圈 Cushion O-Ring
直径 Bore size mm	数量No. 1	数量No. 2	数量No. 2	数量No. 2	数量No. 2	数量No. 1	数量No. 2
φ 50	BDRP-20	BPP-2837	φ 50※ φ 2	φ 46※ φ 22※5	B-QZ8-5042	φ 20※ φ 2.4	φ 8※ φ 1.5
φ 63	BDRP-20	BPP-2837	φ 63※ φ 2	φ 59※ φ 40※5	B-QZ8-6353	φ 20※ φ 2.4	φ 8※ φ 1.5
φ 80	BDRP-25	BPP-3545	φ 80※ φ 2	φ 76※ φ 58※5	B-QZ8-8070	φ 25※ φ 2.4	φ 8※ φ 1.5
φ 100	BDRP-25	BPP-3545	φ 100※ φ 2	φ 96※ φ 77※5	B-QZ8-10090	φ 25※ φ 2.4	φ 8※ φ 1.5

基本尺寸/Basic specification

φ32~φ100

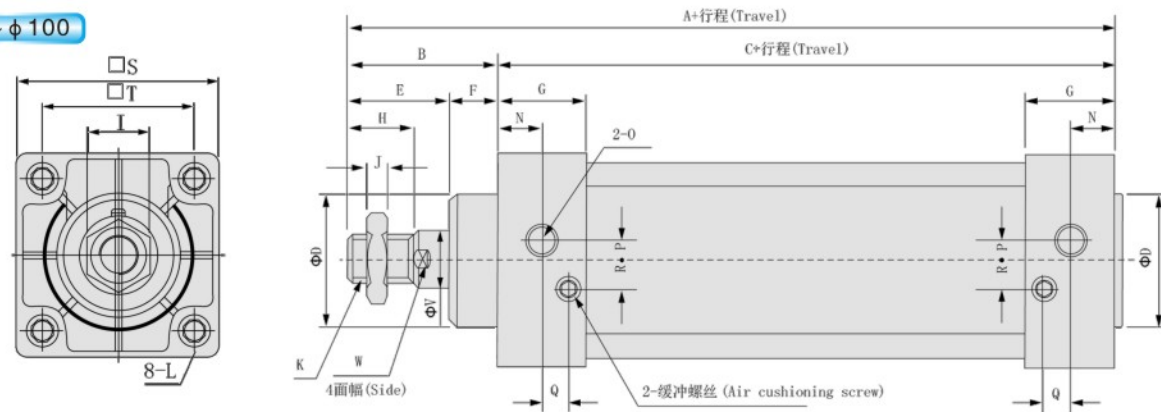

基本尺寸/Basic specification

φ32~φ100

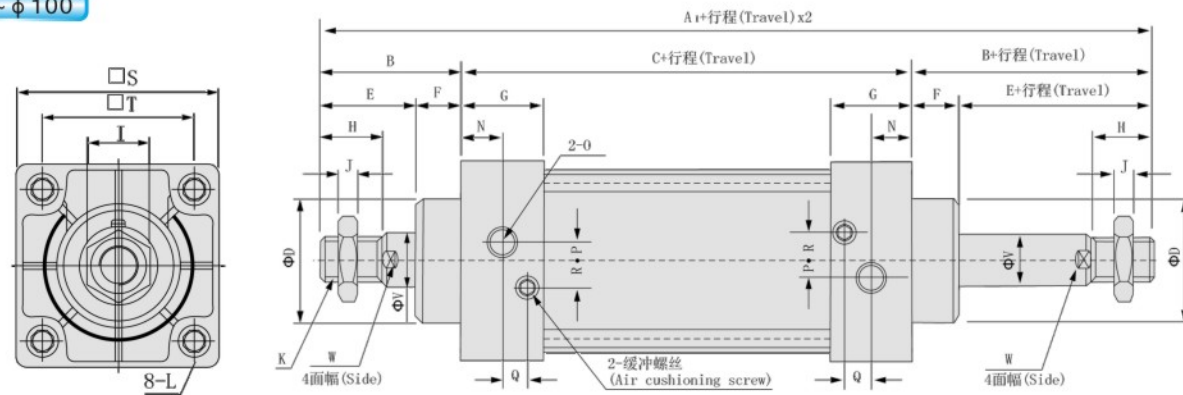

内径/符号 (Bore/Symbol)	A	A ₁	B	C	D	E	F	G	H	I	J	K	L
32	140	187	47	93	28	32	15	27.5	22	17	6	M10×1.25	M6×1
40	142	191	49	93	32	34	15	27.5	24	17	7	M12×1.25	M6×1
50	150	207	57	93	38	42	15	27.5	32	23	8	M16×1.5	M6×1
63	153	210	57	96	38	42	15	27.5	32	23	8	M16×1.5	M8×1.25
80	183	258	75	108	47	54	21	33	40	26	10	M20×1.5	M10×1.5
100	189	264	75	114	47	54	21	33	40	26	10	M20×1.5	M10×1.5
125	203	291	88	115	52	68	20	38	54	41	13.5	M27×2.0	M12×1.75
160	239	352	113	126	62	88	25	38	72	55	18	M36×2.0	M16×2.0
200	244	362	118	126	62	88	30	38	72	55	18	M36×2.0	M16×2.0
250	294	435	141	153	86	106	35	48	84	65	21	M42×2.0	M20×2.5

内径/符号 (Bore/Symbol)	N	O	P	Q	R	S	T	V	W
32	13.7	G1/8	3.5	7.5	7	45	33	12	10
40	13.5	G1/4	6	8.2	9	50	37	16	14
50	13.5	G1/4	8.5	8.2	9	62	47	20	17
63	13.5	G3/8	7	8.2	8.5	75	56	20	17
80	16.5	G3/8	10	9.5	14	94	70	25	22
100	16.5	G1/2	11	9.5	14	112	84	25	22
125	19	G1/2	10	5	20	138	104	32	27
160	19	G3/4	15	6	15	174	134	40	36
200	19	G3/4	15	3	15	214	163	40	36
250	25.5	G1	20	7.5	20	267	202	50	46

安装附件/Mounting kits

B-LB型尺寸/B-LB Size

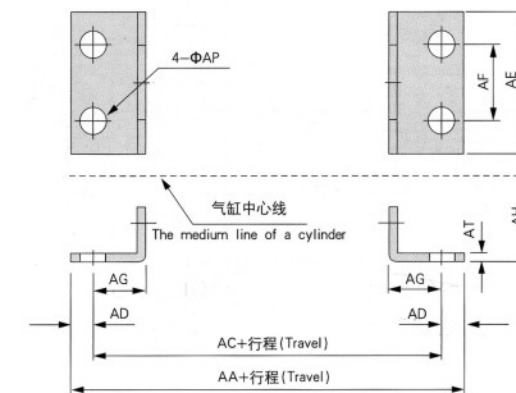

符号/内径 (Symbol/Bore)	32	40	50	63	80	100	125	160	200	250
AA	152	169	173	184	200	210	221	246	276	323
AC	134	140	149	158	168	174	185	206	226	273
AD	9.5	14.5	12	13	16	18	18	20	25	25
AE	50	57	68	80	97	112	138	174	214	267
AF	33	36	47	56	70	84	104	134	163	201
AG	20.5	23.5	28	31	30	30	35	40	50	60
AH	28	30	36.5	41	49	57	70	91	113.5	141
AP	9	12	12	12	14	14	17	17	22	26
AT	3	3	3	3	4	4	6	8	9	15

B-FA型尺寸/B-FA Size
B-FB型尺寸/B-FB Size

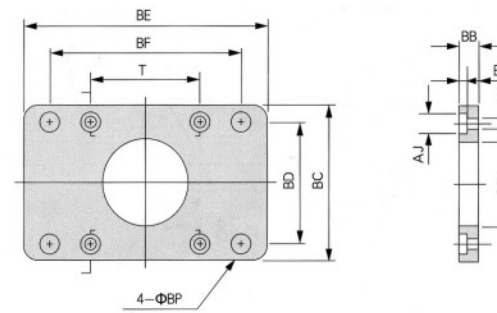

符号/内径 (Symbol/Bore)	32	40	50	63	80	100	125	160	200	250
BA	28.3	32.3	38.3	38.3	47.3	47.5	52.5	62.5	62.5	86.5
BB	10	10	10	12	16	16	20	20	25	25
BC	47	52	65	76	95	115	140	177	217	270
BD	33	36	47	56	70	84	104	134	163	201
BE	72	84	104	116	143	162	196	248	286	356
BF	58	70	86	98	119	138	168	212	250	312
BH	6.5	6.5	6.5	8.5	10.5	10.5	12.5	16.5	16.5	20.5
AJ	10.5	10.5	10.5	13.5	16.5	16.5	19	25	25	31
AK	6.5	6.5	6.5	8.5	10.5	10.5	12.5	16.5	16.5	20.5
BP	7	7	9	9	11	11	14	18	18	22
T	33	37	47	56	70	84	104	134	163	202

B-CA型尺寸/B-CA Size

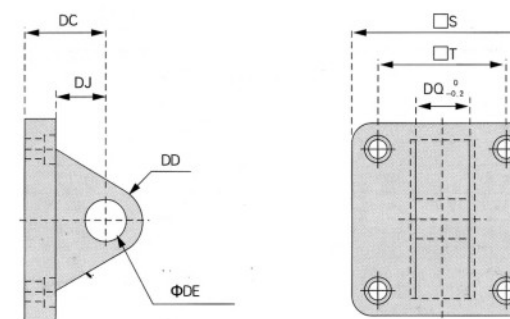

符号/内径 (Symbol/Bore)	32	40	50	63	80	100	125	160	200	250
S	48	50	62	75	94	112	138	173	213	255
T	33	37	47	56	70	84	104	134	163	202
DC	34	34	34	34	48	48	32	40	60	70
DD	14	14	15	15	20	20	20	28	30	36
DE	12	14	14	14	20	20	20	28	28	36
DJ	24	24	24	24	34	34	15	20.5	37	46
DQ	16	20	20	20	32	32	31.7	39.7	39.7	49.7

安装附件/Mounting kits

B-CB型尺寸/B-CB Size

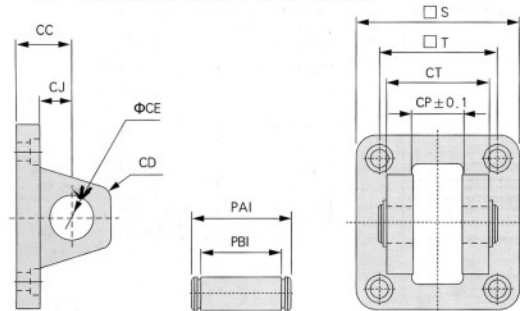

符号/内径 (Symbol/Bore)	32	40	50	63	80	100	125	160	200	250
CC	19	19	19	19	32	32	32	40	60	70
CD	5	5	3	3	8	8	10			
CE	12	14	14	14	20	20	20	28	28	36
CJ	11	11	11	11	21	21	18	25	37	46
CP	16.3	20.3	20.3	20.3	32.3	32.3	32.1	40.1	40.1	50.1
CT	32	44	52	52	64	64	64	80	80	100
PAI	41	51.8	60.3	60.3	73.8	73.8	73	90.2	90.2	130
PBI	33.5	45.5	54	54	65.5	65.5	64.8	80.8	80.8	108
S	48	50	62	75	94	112	138	174	214	267
T	33	37	47	56	70	84	104	134	163	202

B-TC型尺寸/B-TC Size

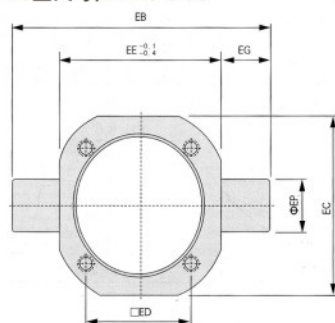

B-SC系列用/Use for B-SC series



B-SCII系列用/Use for B-SCII series

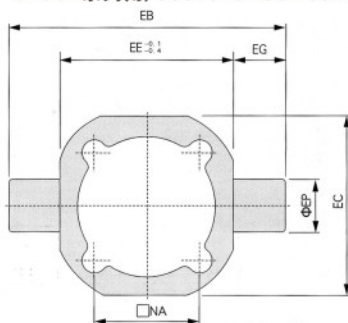

内径/符号(Bore/Symbol)	EB	EC	ED	EE	EG	EP	ET
40	113	63	37	63	25	25	30
50	126	76	47	76	25	25	30
63	138	88	56	88	25	25	30
80	164	114	70	114	25	25	35
100	182	132	84	132	25	25	38
125	208	158	104	158	25	25	40
160	272	200	134	200	36	36	46
200	318	246	163	246	36	36	46
250	394	304	202	304	45	45	56

B-TC-M型/B-TC-M Type

B-SCII系列用/Use for SCII series

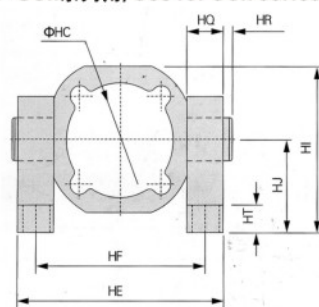

B-TC-M系列用/Use for B-TC-M series

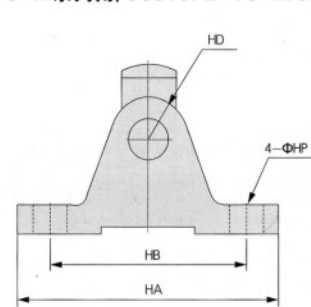

B-SC系列用/Use for B-SC series

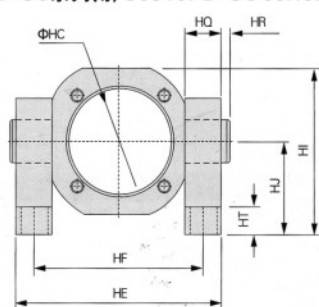

内径/符号(Bore/Symbol)	HA	HB	HE	HF	HJ	HQ	HR	HT	HP
40	110	80	109	86	50	23	2	12	12
50	110	80	122	99	50	23	2	12	12
63	110	80	134	111	50	23	2	12	12
80	120	85	160	137	70	23	2	14	14
100	120	85	178	155	70	23	2	14	14
125	145	105	211	183	85	23	2	20	18
160	185	140	272	236	130	34	2	25	22
200	185	140	318	282	130	34	2	25	22
250	215	165	394	349	160	43	2	28	26

拉杆螺丝 Tie rod screw

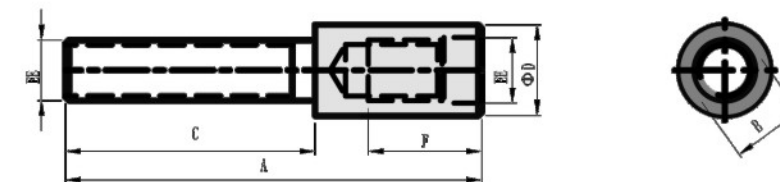

孔径 Bore	符号 Symbol	A	B	C	D	EE	F	订购代码/ Order code	重量/克 Weight(g)
M6		40	6	22.5	9	M6×1.0	18	B-DNG/B-DNC/B-MB/B-SI32/40	10.6
M8		44	8	22.5	12	M8×1.25	18	B-DNG/B-DNC/B-MB/B-SI50/63	19.3
M10		53	10	28	15	M10×1.5	21	B-DNG/B-DNC/B-MB/B-SI80/100	35.1
M12		60	12	30	18	M12×1.75	25	B-DNG/B-DNC/B-MB/B-SI125	65.2

拉杆螺帽 Tie rod nut

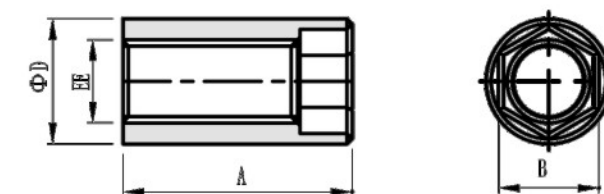

孔径 Bore	符号 Symbol	A	B	D	EE	订购代码 Order code	重量/克 Weight(g)
M6		21.5	6	9	M6×1.0	B-DNG/B-MB32/40 B-SC32/40/50 B-SI32/40	6.2
M8		21.5	8	12	M8×1.25	B-DNG/B-MB50/63 B-SC63/B-SI50/63	11.2
M10		25	10	15	M10×1.5	B-DNG/B-MB80/100 B-SC/B-SI80/100	20.1
M12		25	12	18	M12×1.75	B-MB125	29.5
M12		29	12	18	M12×1.75	B-DNC/B-DNG/B-SI125	34.2
M16		35	17	24	M16×2.0	B-DNG/B-SI160/200	67.5

拉杆螺帽 Tie rod nut

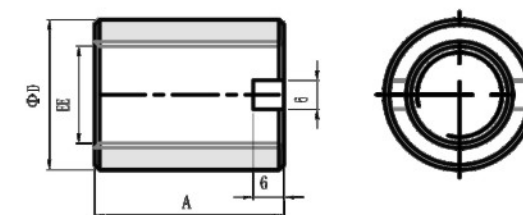

孔径 Bore	符号 Symbol	A	D	EE	订购代码/ Order code	重量/克 Weight(g)
M20		39	31	M20×2.5	B-DNG250	141
M24		44	35	M24×3.0	B-DNG320	210.2

拉杆外形尺寸

TIE BOLT EXTERNAL DIMENSIONS

拉杆 Tie rod

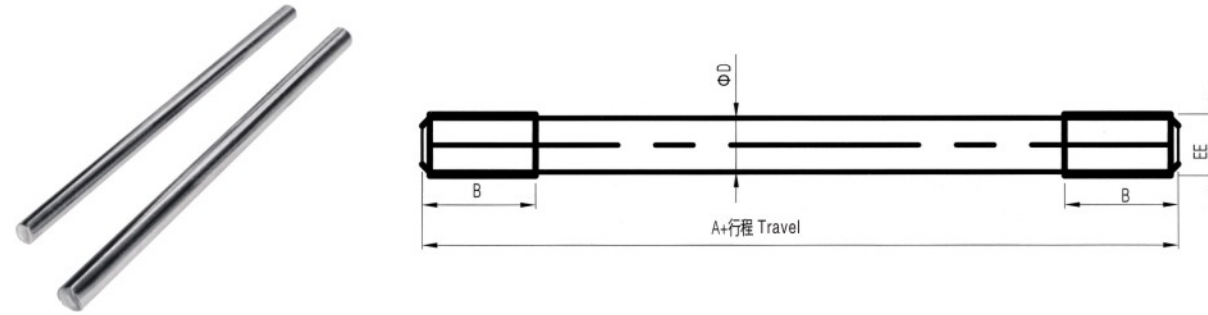

孔径 Bore	符号 Symbol	A		B	D	EE	L	订购代码/ Order code	重量/千克 Weight(kg)
		DNG/SI	MB						
Φ32		67	60	15	5.3	M6×1.0	2000	B-DNG/B-MB/B-SI32	0.3
Φ40		78	60	15	5.3	M6×1.0	2000	B-DNG/B-MB/B-SI40	0.3
Φ50		79	69	15	7	M8×1.25	2000	B-DNG/B-MB/B-SI50	0.6
Φ63		93	69	15	7	M8×1.25	2000	B-DNG/B-MB/B-SI63	0.6
Φ80		96	84	15	9	M10×1.5	2000	B-DNG/B-MB/B-SI80	1.0
Φ100		106	84	15	9	M10×1.5	2000	B-DNG/B-MB/B-SI100	1.0
Φ125		120	88	20	10.8	M12×1.75	2000	B-DNG/B-MB/B-SI125	1.7
Φ160		140		20	14.6	M16×2.0	2000	B-DNG/B-SI160	3.0
Φ200		140		20	14.6	M16×2.0	2000	B-DNG/B-SI200	3.0
Φ250		160		23	18.2	M20×2.5	2000	B-DNG250	4.09
Φ320		170		23	21.9	M24×3.0	2000	B-DNG320	5.92

孔径 Bore	符号 Symbol	A	B	D	EE	L	订购代码/ Order code	重量/千克 Weight(kg)
		SC						
Φ32		67	15	5.3	M6×1.0	2000	B-SC32	0.3
Φ40		68	15	5.3	M6×1.0	2000	B-SC40	0.3
Φ50		68	15	5.3	M6×1.0	2000	B-SC50	0.6
Φ63		70	15	7	M8×1.25	2000	B-SC63	0.6
Φ80		78	15	9	M10×1.5	2000	B-SC80	1.0
Φ100		84	15	9	M10×1.5	2000	B-SC100	1.0
Φ125		79	15	10.8	M12×1.75	2000	B-SC125	1.7
Φ160		84	16	14.6	M16×2.0	2000	B-SC160	3.0
Φ200		84	16	14.6	M16×2.0	2000	B-SC200	3.0
Φ250		97	20	18.2	M20×2.5	2000	B-SC250	4.09

缸筒外形尺寸

CYLINDER TUBE EXTERNAL DIMENSIONS

缸筒 Cylinder tube

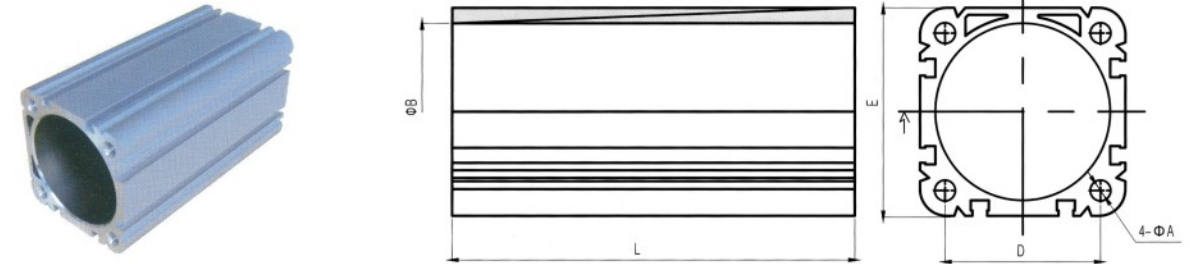

孔径 Bore	符号 Symbol	A	B	D	E	L	订购代码/ Order code	重量/千克 Weight(kg)
Φ32		5.1	32	32.5	45	2500	B-DNC32	5.25
Φ40		5.1	40	38	54	2500	B-DNC40	6.5
Φ50		6.7	50	46.5	64	2500	B-DNC50	11.5
Φ63		6.7	63	56.5	75	2500	B-DNC63	13
Φ80		8.7	80	72	93	2500	B-DNC80	19.25
Φ100		8.7	100	89	110	2500	B-DNC100	26
Φ125		10.7	125	110	134	2500	B-DNC125	44.25

缸筒 Cylinder tube

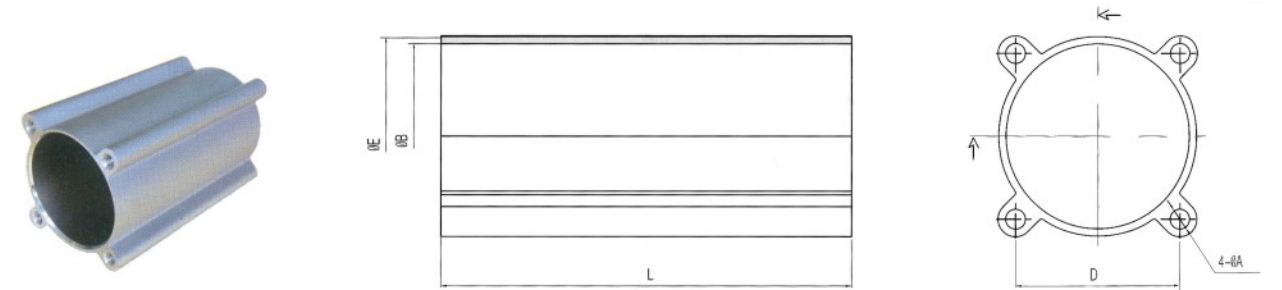

孔径 Bore	符号 Symbol	A	B	D	E	L	订购代码/ Order code	重量/千克 Weight(kg)
Φ32		5.2	32	32.5	36	2500	B-MB/B-DNG/B-SI32	3.5
Φ40		5.2	40	38	45	2500	B-MB/B-DNG/B-SI40	4.0
Φ50		6.8	50	46.5	55	2500	B-MB/B-DNG/B-SI50	5.5
Φ63		6.8	63	56.5	68	2500	B-MB/B-DNG/B-SI63	6.5
Φ80		8.75	80	72	86	2500	B-MB/B-DNG/B-SI80	9.75
Φ100		8.75	100	89	106	2500	B-MB/B-DNG/B-SI100	13.12
Φ125		13.5	125	110	132.5	2000	B-MB/B-DNG/B-SI125	12.3
Φ160		17.5	160	140	168.5	2000	B-DNG/B-SI160	20.3
Φ200		17.5	200	175	210	2000	B-DNG/B-SI200	28.8

缸筒外形尺寸 CYLINDER TUBE EXTERNAL DIMENSIONS

缸筒 Cylinder tube

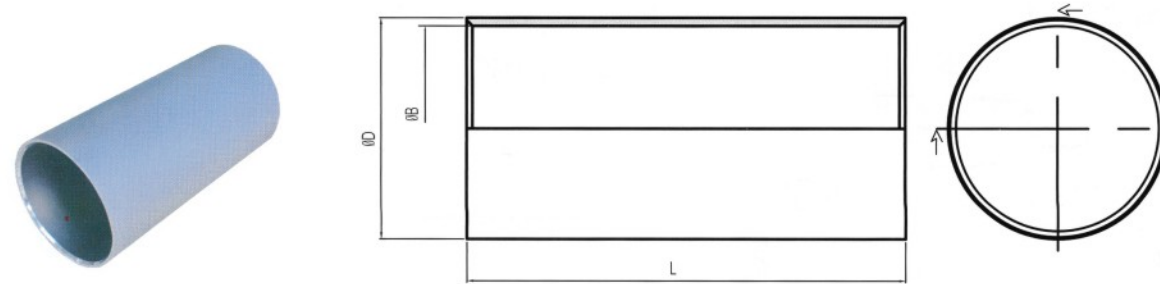

孔径 Bore	符号 Symbol	B	D	L	订购代码/ Order code	重量/千克 Weight(kg)
Φ32		32	37	2500	B-DNG/B-SC/B-SI32	1.87
Φ40		40	45	2500	B-DNG/B-SC/B-SI40	2.12
Φ50		50	55	2500	B-DNG/B-SC/B-SI50	2.5
Φ63		63	68	2500	B-DNG/B-SC/B-SI63	3.5
Φ80		80	86.4	2500	B-DNG/B-SC/B-SI80	5.5
Φ100		100	106	2500	B-DNG/B-SC/B-SI100	6.37
Φ125		125	132.5	2500	B-DNG/B-SC/B-SI125	11.5
Φ160		160	170	2500	B-DNG/B-SC/B-SI160	17
Φ200		200	210	2500	B-DNG/B-SC/B-SI200	23.75
Φ250		250	262	2000	B-DNG/B-SC250	25.4
Φ320		320	336	2000	B-DNG320	42.5

缸筒 Cylinder tube

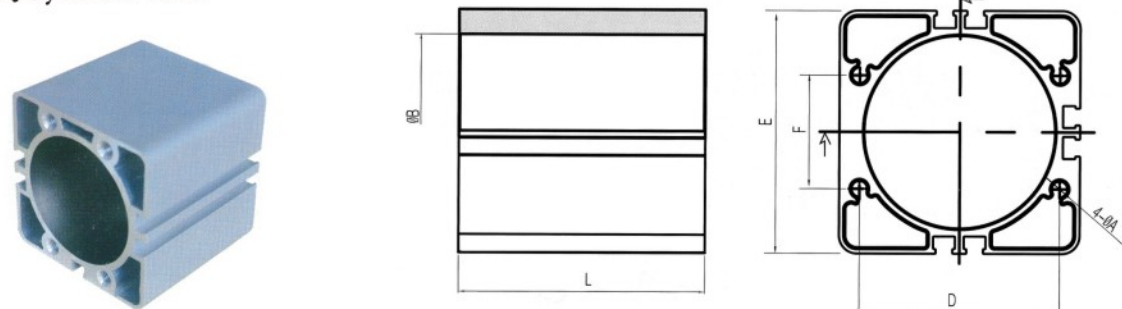

孔径 Bore	符号 Symbol	A	B	D	E	F	L	订购代码/ Order code	重量/千克 Weight(kg)
Φ12		3.6	12	16	27.3	16	2000	B-ADN12	1.88
Φ16		3.6	16	18	28.8	18	2000	B-ADN16	1.9
Φ20		4.6	20	22	35.3	20	2000	B-ADN20	2.67
Φ25		4.6	25	26	39.3	25	2000	B-ADN25	2.96
Φ32		3.6	32	38	47.3	17	2000	B-ADN32	3.2
Φ40		4.6	40	45	56.3	21	2000	B-ADN40	4.67
Φ50		5.5	50	54	66.3	27	2000	B-ADN50	6.0
Φ63		5.5	63	66	79.3	37	2000	B-ADN63	7.0
Φ80		7.2	80	84	99.8	47	2000	B-ADN80	12.2
Φ100		8.1	100	101	119.8	60	2000	B-ADN100	15.2

活塞杆外形尺寸 ROD EXTERNAL DIMENSIONS

活塞杆 Rod

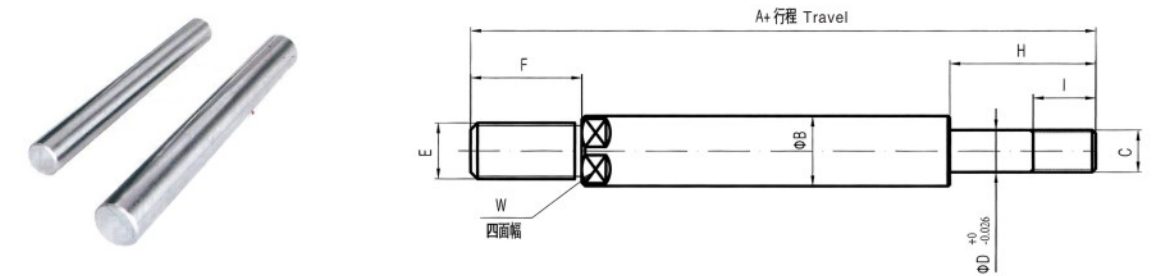

孔径 Bore	符号 Symbol	A	B	C	D	E	F	H	I	W	L	订购代码/ Order code	重量/千克 Weight(kg)
Φ32		117	12	M8	8	M10×1.25	22	32	13.5	10	2000	B-DNC32	1.7
Φ40		131.5	16	M10	10	M12×1.25	24	38	13.5	13	2000	B-DNC40	3.1
Φ50		147	20	M12	12	M16×1.5	32	38	13.5	17	2000	B-DNC50	4.9
Φ63		151	20	M12	12	M16×1.5	32	48	13.5	17	2000	B-DNC63	4.9
Φ80		180.5	25	M16	16	M20×1.5	40	46	16.5	22	2000	B-DNC80	7.7
Φ100		198	25	M16	16	M20×1.5	40	58	16.5	22	2000	B-DNC100	7.7
Φ125		235.5	32	M16	16	M27×2.0	54	52	24	27	2000	B-DNC125	12.5

活塞杆 Rod

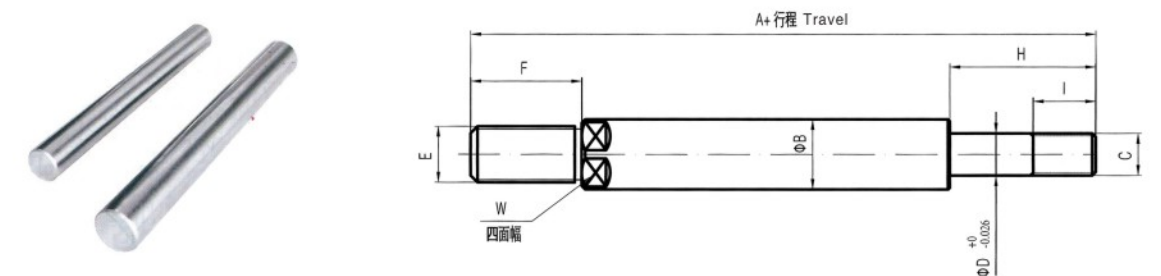

孔径 Bore	符号 Symbol	A	B	C	D	E	F	H	I	W	L	订购代码/ Order code	重量/千克 Weight(kg)
Φ32		117	12	M8	8	M10×1.25	22	32	13.5	10	2000	B-DNG32	1.7
Φ40		131.5	16	M10	10	M12×1.25	24	38	13.5	13	2000	B-DNG40	3.1
Φ50		147	20	M12	12	M16×1.5	32	38	13.5	17	2000	B-DNG50	4.9
Φ63		161	20	M12	12	M16×1.5	32	48	13.5	17	2000	B-DNG63	4.9
Φ80		180.5	25	M16	16	M20×1.5	40	46	16.5	22	2000	B-DNG80	7.7
Φ100		198	25	M16	16	M20×1.5	40	58	16.5	22	2000	B-DNG100	7.7
Φ125		235.5	32	M16	16	M27×2.0	54	52	24	27	2000	B-DNG125	12.5
Φ160		数据参考SI160/SI200											
Φ200		数据参考SI160/SI200											
Φ250		336	50	M30	30	M42×1.5	84	68	28	46	2000	B-DNG250	30.6
Φ320		382	63	M36	36	M48×2.0	96	86	28	55	2000	B-DNG320	48.6

活塞杆Rod

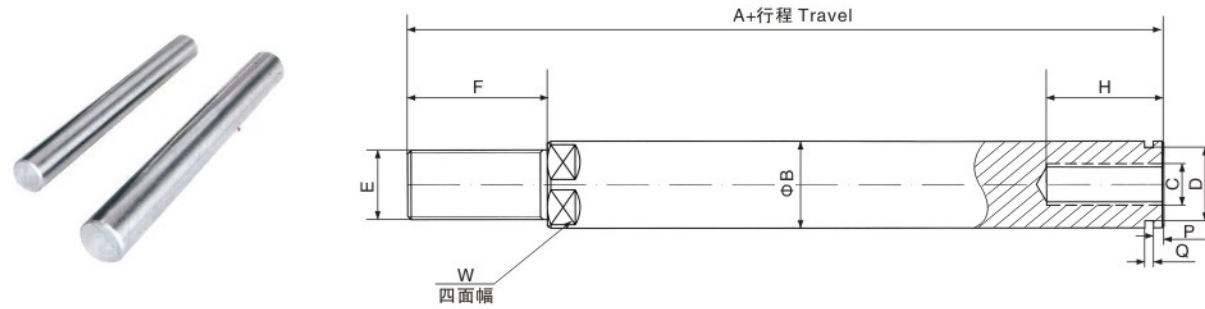

孔径 Bore	符号 Symbol	A	B	C	D	E	F	H	P	Q	W	L	订购代码/ Order code	重量/千克 Weight(kg)
Φ32		82	12	M6	9.6	M10×1.25	22	15	3	1.8	10	2000	B-SI32	1.7
Φ40		93.5	16	M8	12.7	M12×1.25	24	20	3	2.2	13	2000	B-SI40	3.1
Φ50		107.5	20	M10	16	M16×1.5	32	20	3	2.6	17	2000	B-SI50	4.9
Φ63		109.5	20	M10	16	M16×1.5	32	20	3	2.6	17	2000	B-SI63	4.9
Φ80		127	25	M12	21	M20×1.5	40	25	3	2.6	22	2000	B-SI80	7.7
Φ100		136	25	M12	21	M20×1.5	40	25	3	2.6	22	2000	B-SI100	7.7
Φ125		182	32	M16	32.8	M27×2.0	54	35	4	3.5	27	2000	B-SI125	12.5
Φ160		217	40	M20	32.8	M36×2.0	72	35	4	3.5	36	2000	B-SI160	19.5
Φ200		231	40	M20	34.8	M36×2.0	72	35	4	3.5	36	2000	B-SI200	19.5

活塞杆Rod

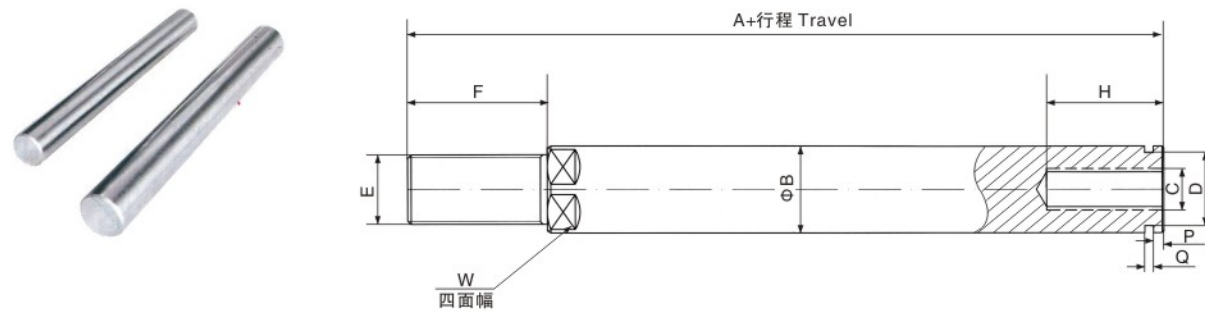

孔径 Bore	符号 Symbol	A	B	C	D	E	F	H	P	Q	W	L	订购代码/ Order code	重量/千克 Weight(kg)
Φ32		80.5	12	M6	9.6	M10×1.25	22	15	3	1.8	10	2000	B-SC32	1.7
Φ40		82.5	16	M8	12.7	M12×1.25	24	20	3	2.2	13	2000	B-SC40	3.1
Φ50		90.5	20	M10	16	M16×1.5	32	20	3	2.6	17	2000	B-SC50	4.9
Φ63		90.5	20	M10	16	M16×1.5	32	20	3	2.6	17	2000	B-SC63	4.9
Φ80		114	25	M12	21	M20×1.5	40	25	3	2.6	22	2000	B-SC80	7.7
Φ100		114	25	M12	21	M20×1.5	40	25	3	2.6	22	2000	B-SC100	7.7
Φ125		132.5	32	M16	32.8	M27×2.0	54	35	4	3.5	27	2000	B-SC125	12.5
Φ160		158.5	40	M20	34.8	M36×2.0	72	35	4	3.5	36	2000	B-SC160	19.5
Φ200		163.5	40	M20	34.8	M36×2.0	72	40	4	3.5	36	2000	B-SC200	19.5
Φ250		199	50	M24	44.8	M42×2.0	84	40	4	3.5	46	2000	B-SC250	30.6

活塞杆Rod

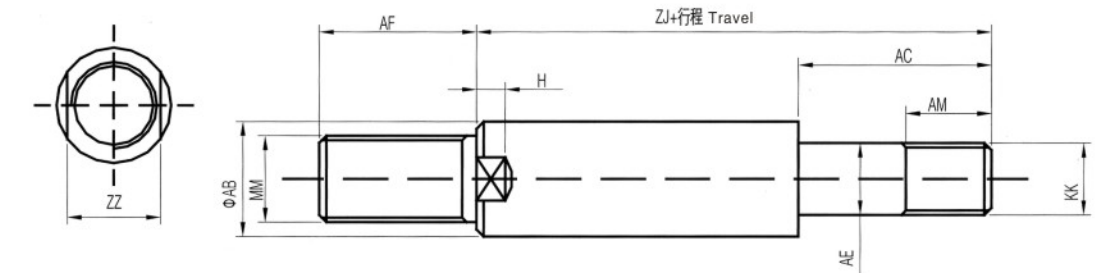
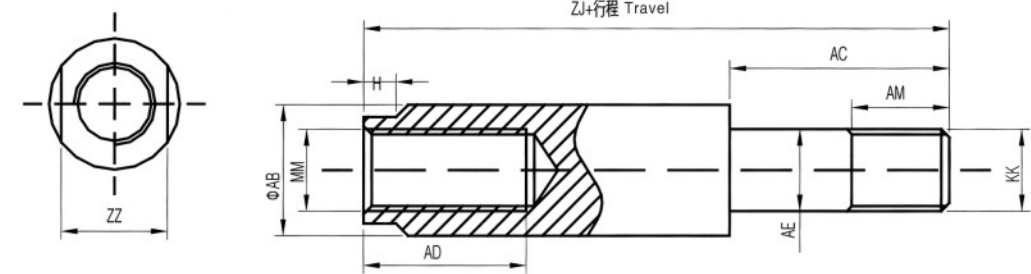

孔径 Bore	符号 Symbol	AB	AC	AD	AE	AF	AM	H	KK	MM	ZJ	ZZ	L	订购代码/ Order code	重量/千克 Weight(kg)
Φ32		12	21	16	8	19	12	3	M8	M8	43	10	2000	B-ADN32	1.7
Φ40		12	22	20	8	19	12	3	M8	M8	44.5	10	2000	B-ADN40	1.7
Φ50		16	22	20	10	22	12	4	M10	M10	46.5	14	2000	B-ADN50	3.1
Φ63		16	27	20	10	22	12	4	M10	M10	50.5	14	2000	B-ADN63	3.1
Φ80		20	29	20	10	28	12	4	M14	M12	55	17	2000	B-ADN80	4.9
Φ100		20	32	20	10	28	12	4	M14	M12	63.5	17	2000	B-ADN100	4.9

DNC



ISO15552 STANDARD
In Accordance with 6431
Spec:32mm~125mm

DNG



ISO15552 STANDARD
In Accordance with 6431
Spec:32mm~320mm

MB



ISO15552 STANDARD
In Accordance with 6431
Spec:32mm~125mm

SI



ISO15552 STANDARD
In Accordance with 6431
Spec:32mm~200mm

SC



AIRTAC STANDARD
In Accordance with 6430
Spec:32mm~160mm

配件PU/Assembling Part PU

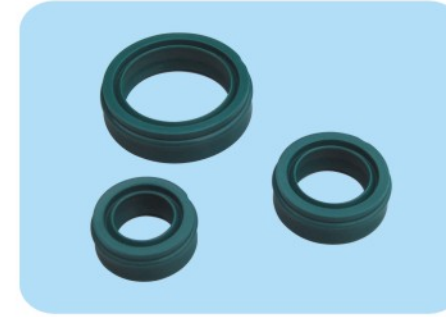

防尘圈
Anti dust seals

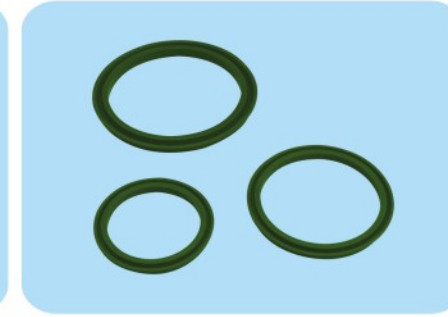

活塞圈
Piston ring



缓冲圈
Cushioning seals

配件NBR/Assembling Part NBR



防尘圈
Anti dust seals

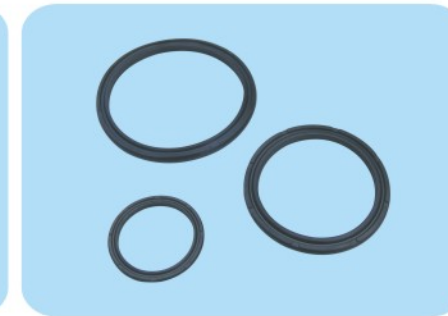

活塞圈
Piston ring



缓冲圈
Cushioning seals

共用件/Common Part

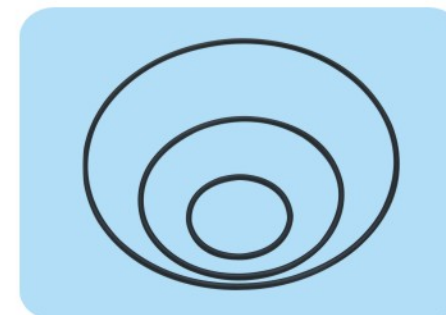

管壁O型圈
O-ring for front cover

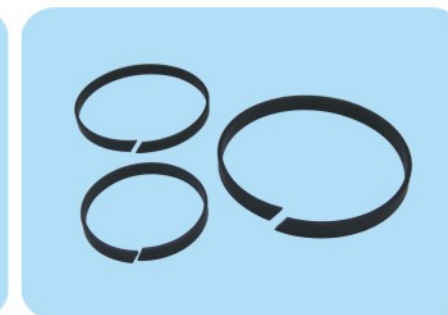

导向带
Wearing ring

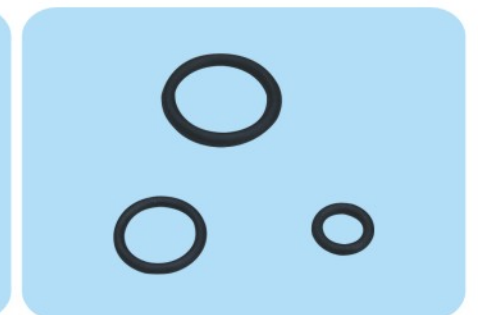

轴芯垫
O-ring for piston and piston rod

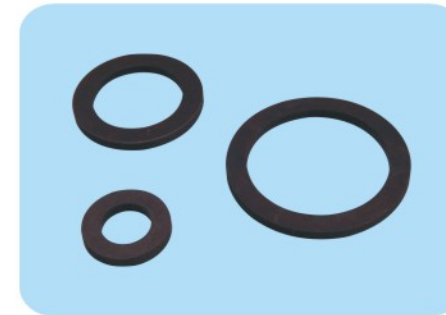

磁环
Magnet

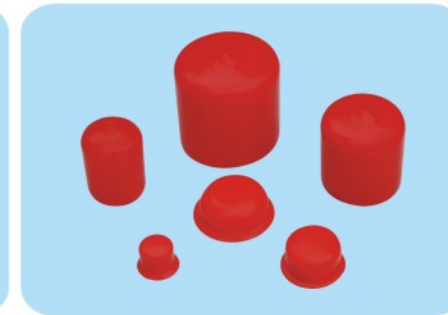

防护帽
Protective cover



磁性开关
Magnetic sensor

五金件/Hardware Part



拉杆螺丝
Tie-rod screw



针阀
Air cushioning screw



活塞固定螺帽
Nut for piston and piston rod fixed



含油轴承
Oil bearing



拉杆螺帽
Tie-rod nuts



活塞杆螺帽
Nut for piston rod

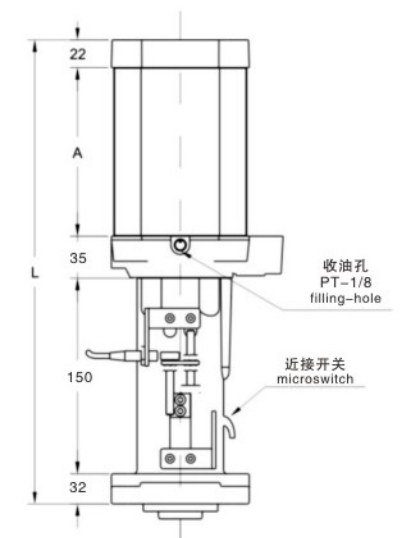
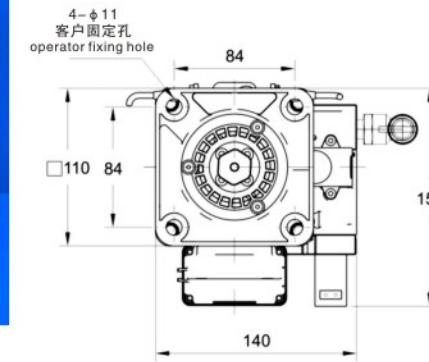

产品规格/Product Specification

规格 specification	2T		3.5T		4.5T		6T		
动作方式 action type	气缸、油缸均双动 pneumatic and hydraulic, all double action								
工作介质 work medium	经三联件过滤处理的压缩空气 compressed air filtered by F.R.L. combination								
气缸耐压 operation pressure range	1.0MPa								
工作温度℃ available temperature	-5-60								
接管口径 port size	PT3/8								
0.6MPa下输出力 output force under 0.6Mpa	2T		3.5T		4.5T		6T		
重量(Kg) kilogram									
规格	2.0T×ST13	2.0T×ST15	2.0T×ST17	2.5T×ST13	2.5T×ST15	2.5T×ST17	3.0T×ST13	3.0T×ST15	3.0T×ST17
A	98	108	118	112	123	131	130	146	162
L	339	349	359	353	365	372	371	387	403
规格	3.5T×ST13	3.5T×ST15	3.5T×ST17	4.5T×ST13	4.5T×ST15	4.5T×ST17	6T×ST15	6T×ST18	
A	130	146	162	157	177	196	222	260	
L	371	395	411	398	418	437	519	557	

表示符号/Symble

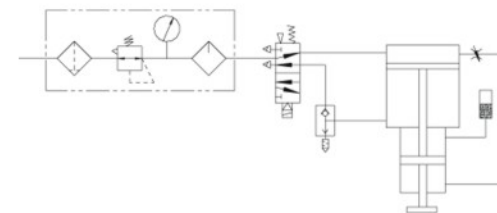

型号说明/Model instruction

DNPM 25T 50X13 A

型号规格
model specification
(打刀缸)
unclamping cylinder

25T: 输出2.5吨
25T:boosting force 2.5T
35T: 输出3.5吨
35T:boosting force 3.5T
45T: 输出4.5吨
45T:boosting force 4.5T
65T: 输出6吨
65T:boosting force 6T

液压缸缸径x打刀行程
Hydraulic cylinder bore size x stroke

50x13: 油缸缸径Φ50, 行程13mm
50x13:Hydraulic cylinder bore size Φ50, stroke 13mm
50x15: 油缸缸径Φ50, 行程15mm
50x15:Hydraulic cylinder bore size Φ50, stroke 15mm
50x17: 油缸缸径Φ50, 行程17mm
50x17:Hydraulic cylinder bore size Φ50, stroke 17mm

微动开关
Microswitch

空白: D不附微动开关
Blank: D without microswitch
L:2个微动开关
L:2 microswitch

接电方式
electrical
connection mode

A: AC220V
B: DC24V
C: AC110V
E: AC24V
F: DC12V



安装尺寸：底座安装尺寸

Mounting dimensions:
Base Mounting dimensions

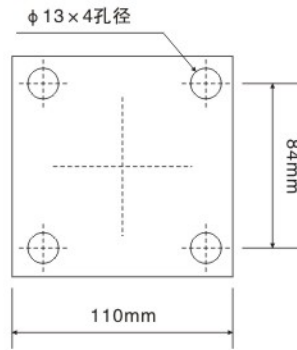

产品规格/Product Specification

规格(增压比)specification (boosting ratio)	16	12.75	8.16	6.25	4.94
动作方式 action type	气缸、油缸均双动 pneumatic and hydraulic, all double action				
工作介质 work medium	经三联件过滤处理的压缩空气 compressed air filtered by F.R.L. combination				
气缸耐压 operation pressure range	1.0MPa				
工作温度℃ available temperature	-5-60				
接管口径 port size	PT3/8				
0.6MPa下输出力 output force under 0.6Mpa	9.6MPa	7.65MPa	4.896MPa	3.75MPa	2.96MPa
重量(Kg) kilogram					

表示符号/Symble

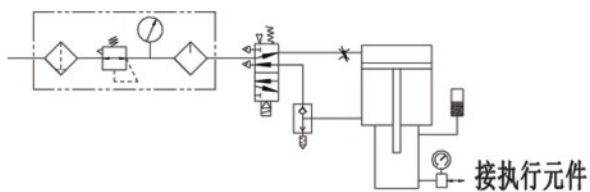

型号说明/Model instruction

型号规格
model specification
(打刀缸)
unclamping cylinder

DNZG 16- 50cc A

型号规格
modelpecification
(增压缸)
boosting cylinder

- 16: 倍增16
16:boost ratio16
- 12.75: 倍增12.75
12.75:boost ratio12.75
- 8.15: 倍增8.15
8.15:boost ratio8.15
- 6.25: 倍增6.25
6.25:boost ratio6.25
- 4.94: 倍增4.94
4.94:boost ratio4.94

输出流量: cc
output flow: milliliter

- 50cc
- 60cc
- 80cc
- 110cc
- 160cc

接电方式
electrical
connection mode

- A: AC220V
- B: DC24V
- C: AC110V
- E: AC24V
- F: DC12V

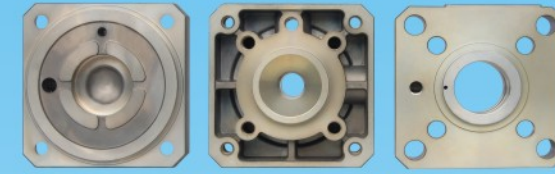

CNC打刀缸盖/CNC Unclamping Cylinder Cover

轴径/DIA	Φ14	Φ16	Φ18	Φ20
最大压力/Max Pressure	6T	4.5T	3.5T	2T

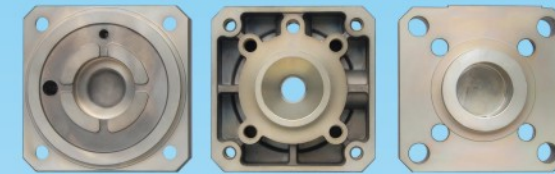

CNC增压缸盖/CNC Boosting Cylinder Cover

轴径/DIA	Φ45	Φ40	Φ30	Φ28	Φ25	Φ22
最大压力/Max Pressure	x4	x6.25	x8	x12.7	x16	x21

动力单元油路块
Power Unit Block



刹车器本体
Brake



扒胎气缸端盖
Tyre Changer Cylinder Cover



铝压铸/Aluminium Die Casting



数控加工/CNC Machining

